

UZA-50001

Zaab 1 Floodlight



* Pictured with A54131 Snoot

21w COB 1739 Lumens
IP66 • Suitable For Wet Locations
IK07 • Impact Resistant (Vandal Resistant)
Weight 6.1 lbs

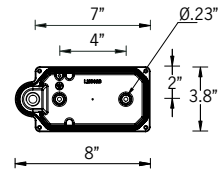
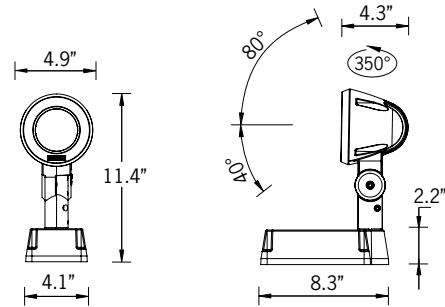

Mounting Detail

Construction

Aluminum

Less than 0.1% copper content – Marine Grade 6060 extruded & LM6 Aluminum High Pressure die casting provides excellent mechanical strength, clean detailed product lines and excellent heat dissipation.

Pre paint

8 step degrease and phosphate process that includes deoxidizing and etching as well as a zinc and nickel phosphate process before product painting.

Memory Retentive -Silicon Gasket

Provided with special injection molded “fit for purpose” long life high temperature memory retentive silicon gaskets. Maintains the gaskets exact profile and seal over years of use and compression.

Thermal management

LM6 Aluminum is used for its excellent mechanical strength and thermal dissipation properties in low and high ambient temperatures. The superior thermal heat sink design by Ligman used in conjunction with the driver, controls thermals below critical temperature range to ensure maximum luminous flux output, as well as providing long LED service life and ensuring less than 10% lumen depreciation at 50,000 hours.

Surge Suppression

Standard 10kv surge suppressor provided with all fixtures.

BUG Rating

B4 - U5 - G5

Finishing

All Ligman products go through an extensive finishing process that includes fettling to improve paint adherence.

Paint

UV Stabilized 4.9Mil thick powder coat paint and baked at 200 Deg C. This process ensures that Ligman products can withstand harsh environments. Rated for use in natatoriums.

Hardware

Provided Hardware is Marine grade 316 Stainless steel.

Anti Seize Screw Holes

Tapped holes are infused with a special anti seize compound designed to prevent seizure of threaded connections, due to electrolysis from heat, corrosive atmospheres and moisture.

Crystal Clear Low Iron Glass Lens

Provided with tempered, impact resistant crystal clear low iron glass ensuring no green glass tinge.

Optics & LED

Precise optic design provides exceptional light control and precise distribution of light. LED CRI > 80

Lumen - Maintenance Life

L80 /B10 at 50,000 hours (This means that at least 90% of the LED still achieve 80% of their original flux)

Adjustable surface spotlight family. Conical, stylish spotlight range with a wealth of options and accessories.

The Zaab family of floodlights have a modern aesthetic design and are a perfect lighting solution for most small to medium size spotlight and floodlight requirements. The floodlights can be aimed and locked in place to highlight specific features or elements in the environment, as well as provide security when illuminating dark areas on campuses and parks. This small and medium range of high performance LED floodlight luminaires provides a robust design for demanding applications such as recreational areas, public spaces and architectural structures.

The luminaire has integrated heat sinks to facilitate LED cooling, as well as an integral driver. The Zaab is available in Narrow, Medium, Wide and Very Wide light distributions. Color temperature 2700K, 3000K, 3500K and 4000K.

Luminaire has optional accessories, such as visors, louvres, and linear spread lenses. For non standard fixture variations, as well as specific reflector requirements and dichroic filters, please contact the factory.

Additional Options (Consult Factory For Pricing)



A52431
Anti Glare Visor



A52531
Anti Glare Hood



A51621
Anti Glare Louvre



A50914
Linear Spread Lens



A54131
Snoot



Dichroic Color Filters

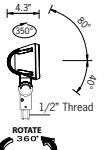

TKM
1/2" Threaded
Knuckle Mount



UZA-50001

Zaab 1 Floodlight

PROJECT	<input type="text"/>	DATE	<input type="text"/>
----------------	----------------------	-------------	----------------------

QUANTITY	<input type="text"/>	TYPE	<input type="text"/>	NOTE	<input type="text"/>
-----------------	----------------------	-------------	----------------------	-------------	----------------------

ORDERING EXAMPLE || UZA - 50001 - 21w COB - N - W30 - 02 - 120/277v

LAMP	BEAM	LED COLOR	FINISH COLOR	VOLTAGE
21w COB 1739 Lumens	N - Narrow 14° M - Medium 25° W - Wide 51°	W27 - 2700K W30 - 3000K W35 - 3500K W40 - 4000K	01 - BLACK RAL 9011 02 - DARK GREY RAL 7043 03 - WHITE RAL 9003 04 - METALLIC SILVER RAL 9006 05 - MATTE SILVER RAL 9006 06 - LIGMAN BRONZE 07 - CUSTOM RAL	120/277v Other - Specify



<input type="text"/>	<input type="text"/>	<input type="text"/>	<input type="text"/>
----------------------	----------------------	----------------------	----------------------

ADDITIONAL OPTIONS

- | | | |
|---------------------------|-----------------------------------|-------------------------------|
| F - Frosted Lens | A51621 - Anti Glare Louvre | DICHROIC COLOR FILTERS |
| DIM - 0-10v Dimming | A50914 - Linear Spread Lens | A50916 - Red Color Filter |
| NAT - Natatorium Rated | A54131 - Snoot | A50917 - Blue Color Filter |
| A52431 - Anti Glare Visor | TKM - 1/2" Threaded Knuckle Mount | A50918 - Amber Color Filter |
| A52531 - Anti Glare Hood | | A50919 - Green Color Filter |

Zaab Product Family



Zaab 1

• UZA-50001-21w-1739lm



Zaab 2

• UZA-50011-40w-4019lm



Zaab 3

• UZA-20001-3x40w-3x4091lm
• UZA-20011-6x40w-6x4091lm