

INSTALLATION AND SERVICE MANUAL

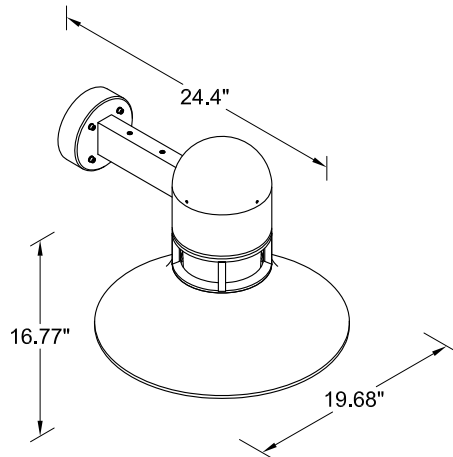

For installation of Columbus medium shade wall light.
Model. UCO-30161-170.

Product drawing (dimensions)



SUITABLE FOR WET LOCATIONS

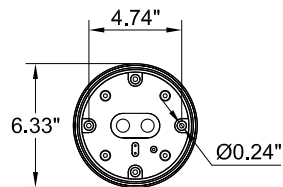

MOUNTING DETAIL

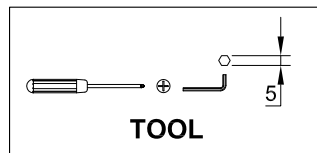

NOTE

Mounts over
a 3"Octagonal
Junction box.

1

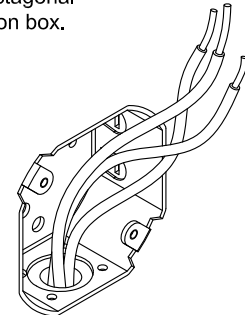

4

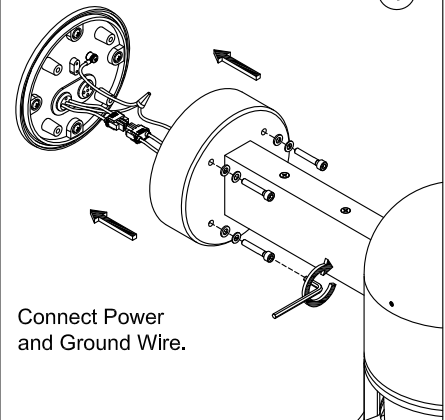

Connect Power
and Ground Wire.

2

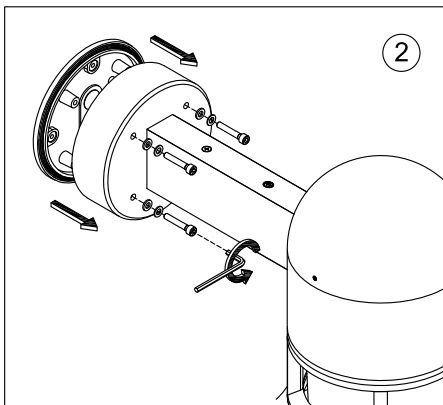

Position the Back Plate
over the J Box and
Secure the back
plate to the wall

3

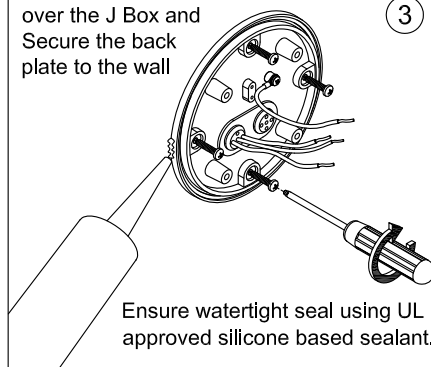

Ensure watertight seal using UL
approved silicone based sealant.

5

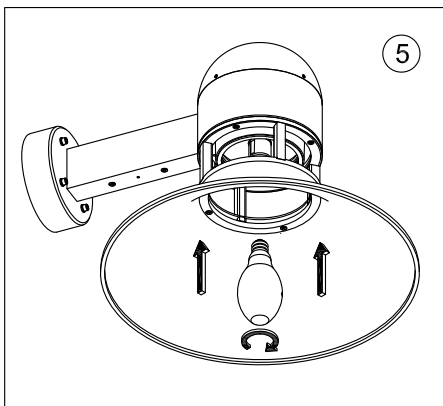

6

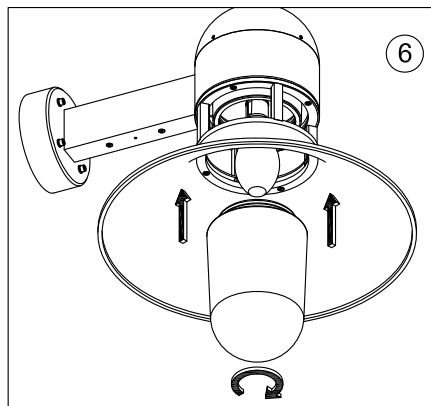

7

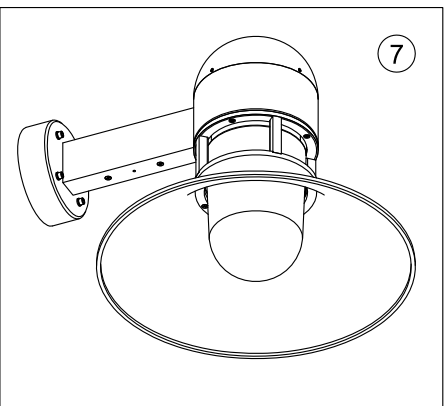

Notice to installer :

1. **WIRING INSTRUCTIONS** Warning : RISK OF FIRE AND ELECTRICAL SHOCK. : FIXTURE MUST BE INSTALLED BY A QUALIFIED ELECTRICIAN ONLY>FIXTURE IS INTENDED FOR INSTALLATION IN ACCORDANCE WITH THE NATIONAL ELECTRICAL CODE, LOCAL AND FEDERAL CODE SPECIFICATIONS. DISCONNECT POWER BEFORE SERVICING.
2. This fixture has a **VOLTAGE SPECIFIC BALLAST**, Check that the supply voltage is the same as the installed ballast voltage.

Ligman Lighting USA

7144 NW Progress Court, Hillsboro
Oregon, 97124, USA
Tel : 503 645 0500 | Fax : 503 645 8100

www.ligmanlightingusa.com

UCO-30161/21/09/12/REV.2
1/1

ISO 9001
ISO 14001
BUREAU VERITAS
Certification



FM-TS-13/25-05-2007-REV.2