

For installation of Tango 2,12 cylindrical and square wall up-down light.
Model. UTA-30381-30383, UTA-30385 and UTA-30731-30733, UTA-30735.

Product drawing (dimensions)

SUITABLE FOR WET LOCATIONS

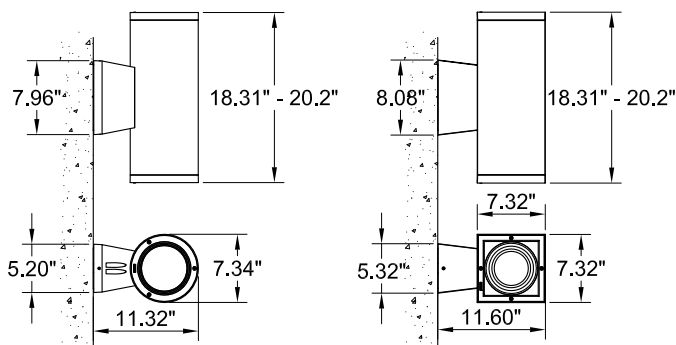

UTA-30381-30383, UTA-30385

UTA-30731-30733, UTA-30735

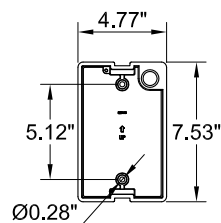

MOUNTING DETAIL

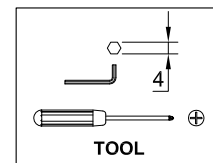

TOOL

NOTE

Mounts over a 3" Octagonal Junction box.

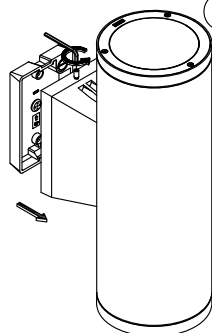
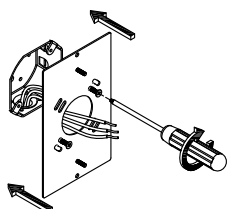
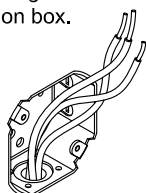

Center the Back Plate over the J Box and Secure the back plate to the wall

Ensure watertight seal using UL approved silicone based sealant.

Connect Power and Ground Wire.

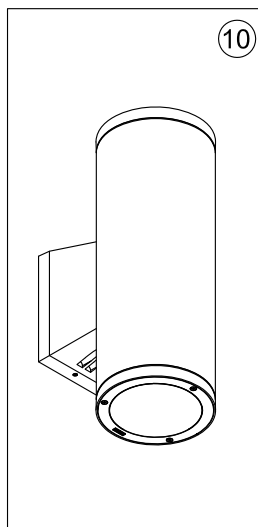
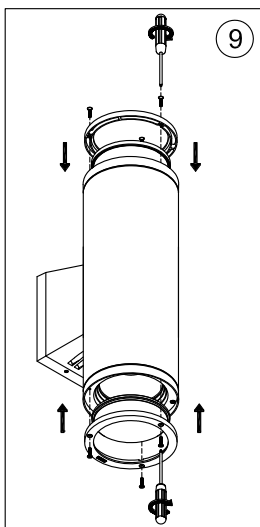
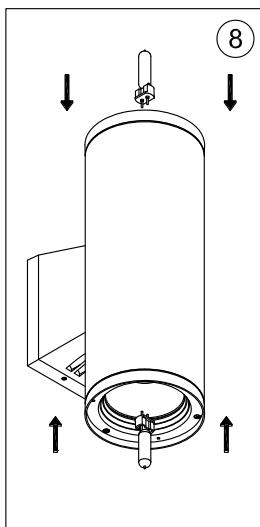
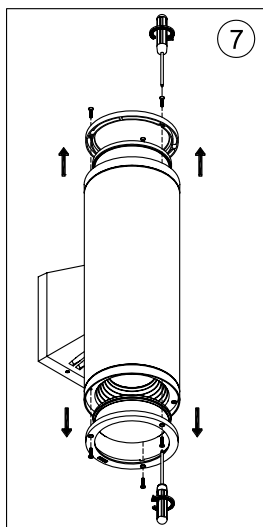
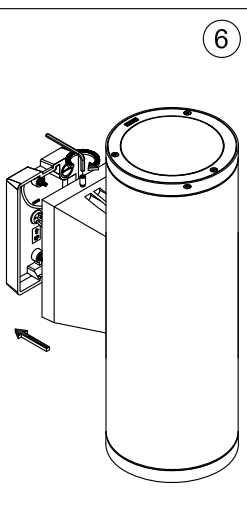
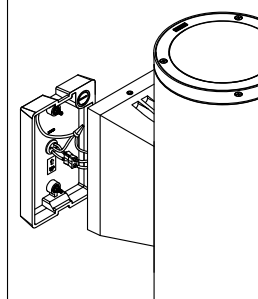

Notice to installer :

- 1.WIRING INSTRUCTIONS** Warning : RISK OF FIRE AND ELECTRICAL SHOCK. : FIXTURE MUST BE INSTALLED BY A QUALIFIED ELECTRICIAN ONLY>FIXTURE IS INTENDED FOR INSTALLATION IN ACCORDANCE WITH THE NATIONAL ELECTRICAL CODE, LOCAL AND FEDERAL CODE SPECIFICATIONS. DISCONNECT POWER BEFORE SERVICING.
- 2.This fixture has a VOLTAGE SPECIFIC BALLAST, Check that the supply voltage is the same as the installed ballast voltage.**

Ligman Lighting USA

7144 NW Progress Court, Hillsboro
Oregon, 97124, USA
Tel : 503 645 0500 | Fax : 503 645 8100

www.ligmanlightingusa.com

UTA-30381/13/06/14/REV.1
1/1



FM-TS-13/25-05-2007-REV.2