

INSTALLATION AND SERVICE MANUAL

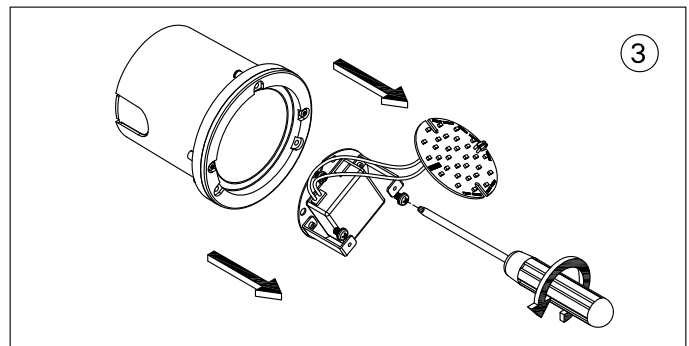

For installation of Vios recessed guide light LEDs.
Model. UVI-40282, UVI-40292-96, UVI-40302-06, UVI-40312-16, UVI-40322-26.

Product drawing (dimensions) SUITABLE FOR WET LOCATIONS

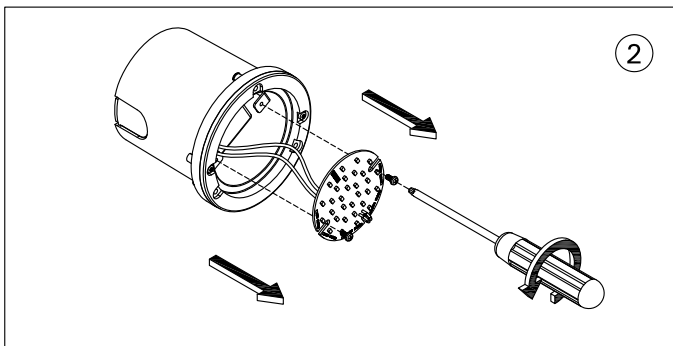
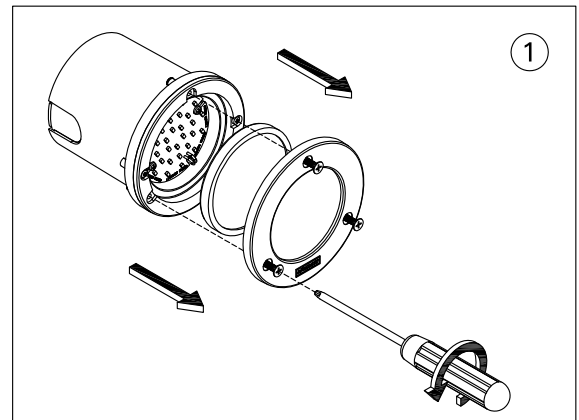
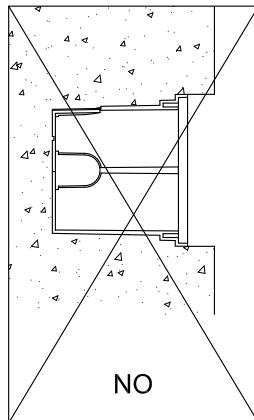
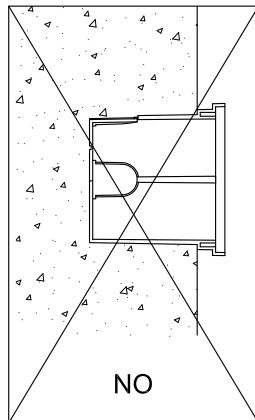
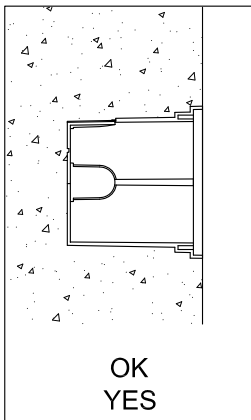
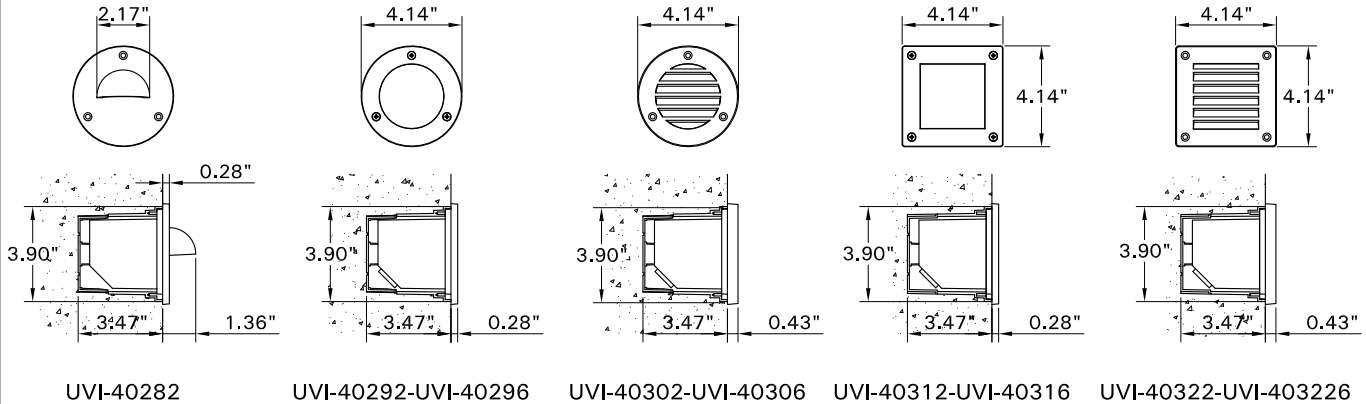

Notice to installer :

- 1.WIRING INSTRUCTIONS** Warning : RISK OF FIRE AND ELECTRICAL SHOCK. : FIXTURE MUST BE INSTALLED BY A QUALIFIED ELECTRICIAN ONLY>FIXTURE IS INTENDED FOR INSTALLATION IN ACCORDANCE WITH THE NATIONAL ELECTRICAL CODE, LOCAL AND FEDERAL CODE SPECIFICATIONS. DISCONNECT POWER BEFORE SERVICING.
- 2.This fixture has a VOLTAGE SPECIFIC BALLAST**, Check that the supply voltage is the same as the installed ballast voltage.

Ligman Lighting USA

Tanasbourne Commerce Center
3302 Nw 211th Terrace
Hillsboro Oregon 97124
Tel : 503-645-0500, Fax : 503-645-8100

www.ligmanlightingusa.com

UVI-40282 18/12/14 REV.1
1/2

ISO 9001
ISO 14001
BUREAU VERITAS
Certification



FM-TS-13/25-05-2007-REV.2

