

For installation of Atlantic wall light.
Model. UAA-30811-30816.

Product drawing (dimensions)

SUITABLE FOR WET LOCATIONS

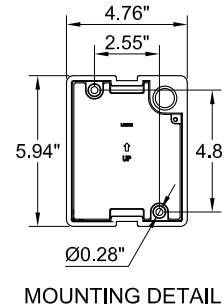
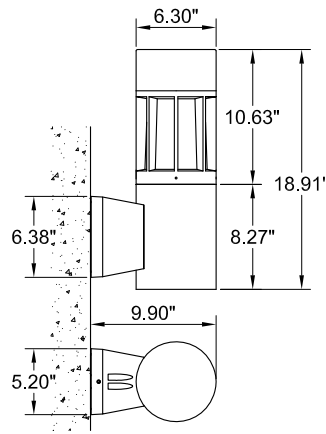
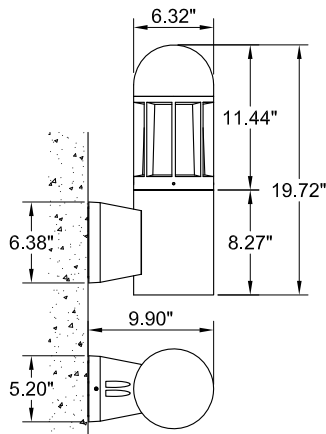

MOUNTING DETAIL

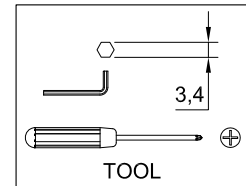

TOOL

NOTE

Mounts over
a 3"Octagonal
Junction box.

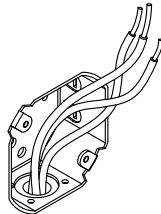

1

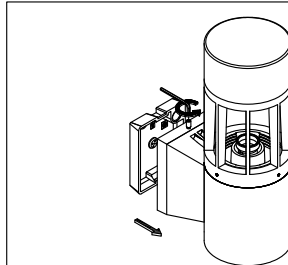

2

Center the Back Plate over the
J Box and Secure the back
plate to the wall

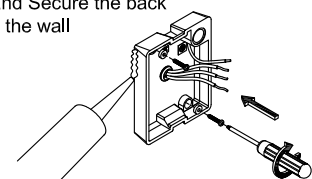

3

Ensure watertight seal using UL
approved silicone based sealant.

4

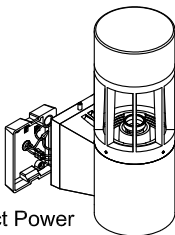

Connect Power
and Ground Wire.

5

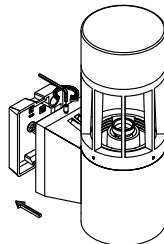

6

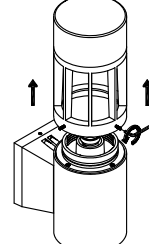

Install lamp

7

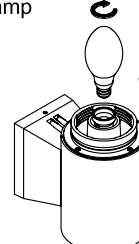

8

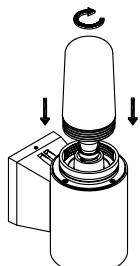

9

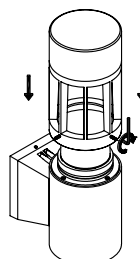

10

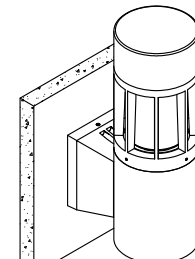

Notice to installer :

1. **WIRING INSTRUCTIONS** Warning : RISK OF FIRE AND ELECTRICAL SHOCK. : FIXTURE MUST BE INSTALLED BY A QUALIFIED ELECTRICIAN ONLY>FIXTURE IS INTENDED FOR INSTALLATION IN ACCORDANCE WITH THE NATIONAL ELECTRICAL CODE, LOCAL AND FEDERAL CODE SPECIFICATIONS. DISCONNECT POWER BEFORE SERVICING.
2. This fixture has a **VOLTAGE SPECIFIC BALLAST**, Check that the supply voltage is the same as the installed ballast voltage.

Ligman Lighting USA

7144 NW Progress Court, Hillsboro
Oregon, 97124, USA
Tel : 503 645 0500 | Fax : 503 645 8100

www.ligmanlightingusa.com

UAA-30811/25/09/12/REV.0

1/1



FM-TS-13/25-05-2007-REV.2