

Euroman wall light

IP55 ✱ ▲ ▲ / EN 60598/CLASS I ⚡ / ▽ / CE / IK08









Suitable for wet locations

A decorative wall lantern with excellent downward symmetrical light distribution. Developed to compliment the Euroman post top and street lanterns. Designed for lighting of entrances, footpaths and car parks.

Low copper content die-cast aluminum housing with high corrosion resistance. Stainless steel screws. Durable silicone rubber gasket and clear or opal impact resistant UV stabilized polycarbonate diffuser. Housing is treated with a chemical chromatized protection before powder coating, ensuring high corrosion resistance. Integral control gear. Anodized high purity aluminum reflector with the clear diffuser option.



					
- 01. Black RAL 9011	- 02. Dark Grey RAL 7043	- 03. White RAL 9003	- 04. Metalic Silver RAL 9006	- 05. Matt Silver RAL 9006	- 06. Bronze RAL 6014

Product Family



P.315 Euroman



P.641 Euroman



UER-30961-1-C

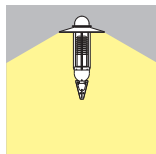

Euroman clear diffuser

Model No.	Lamp	Holder	Lumen	Weight	Picture
UER-30961-1-C	CFQ 26w./CFTR 32/42w.	G24q-3/4	1550/2040/2720	28.2 lb.	1
UER-30962-1-C	PMH-ED17 50w.	MED	2100	31.9 lb.	1
UER-30963-1-C	PMH-ED17 70w.	MED	4000	31.9 lb.	1
UER-30964-1-C	HPS-ED17 50w.	MED	3600	31.9 lb.	1
UER-30965-1-C	HPS-ED17 70w.	MED	5450	31.9 lb.	1
UER-30961-2-C	CFQ 26w./CFTR 32/42w.	G24q-3/4	1550/2040/2720	28.2 lb.	2
UER-30962-2-C	PMH-ED17 50w.	MED	2100	31.9 lb.	2
UER-30963-2-C	PMH-ED17 70w.	MED	3600	31.9 lb.	2
UER-30964-2-C	HPS-ED17 50w.	MED	3600	31.9 lb.	2
UER-30965-2-C	HPS-ED17 70w.	MED	5450	31.9 lb.	2

*Contact factory for LED options

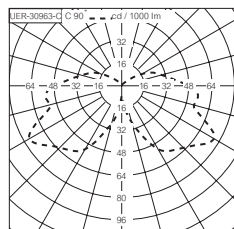
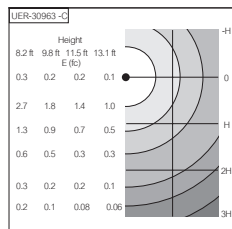

UER-30961-1-O

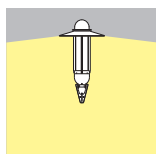

Euroman opal diffuser

Model No.	Lamp	Holder	Lumen	Weight	Picture
UER-30961-1-O	CFQ 26w./CFTR 32/42w.	G24q-3/4	1550/2040/2720	27.3 lb.	1
UER-30962-1-O	PMH-ED17 50w.	MED	2100	31.0 lb.	1
UER-30963-1-O	PMH-ED17 70w.	MED	4000	31.0 lb.	1
UER-30964-1-O	HPS-ED17 50w.	MED	3600	31.0 lb.	1
UER-30965-1-O	HPS-ED17 70w.	MED	5450	31.0 lb.	1
UER-30961-2-O	CFQ 26w./CFTR 32/42w.	G24q-3/4	1550/2040/2720	27.3 lb.	2
UER-30962-2-O	PMH-ED17 50w.	MED	2100	31.0 lb.	2
UER-30963-2-O	PMH-ED17 70w.	MED	3600	31.0 lb.	2
UER-30964-2-O	HPS-ED17 50w.	MED	3600	31.0 lb.	2
UER-30965-2-O	HPS-ED17 70w.	MED	5450	31.0 lb.	2

*Contact factory for LED options

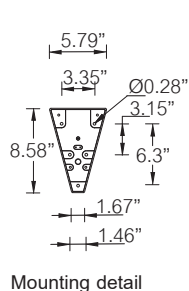
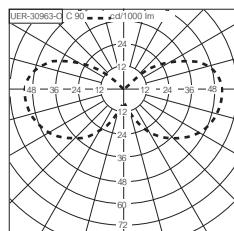
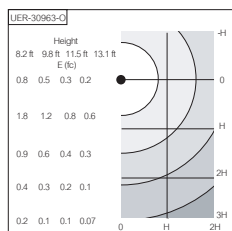

Mounting detail

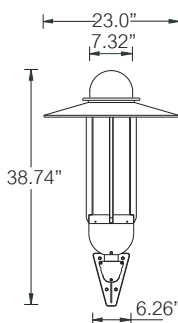

Picture 1

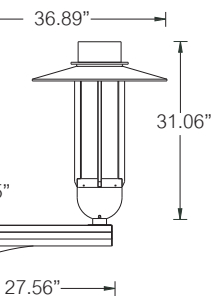
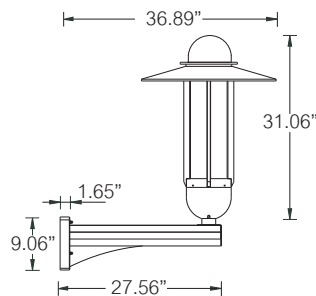

Picture 2

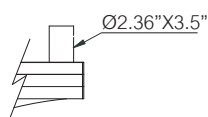

Tenon arm bracket



(C) Clear diffuser



(O) Opal diffuser



(1) Dome top



(2) Flat top