

For Installation of Steamer Street and area lighting LED.
Model. USE-90001, USE-90011, USE-90021, USE-90031 & Accessory

Product drawing (dimensions)

SUITABLE FOR WET LOCATIONS

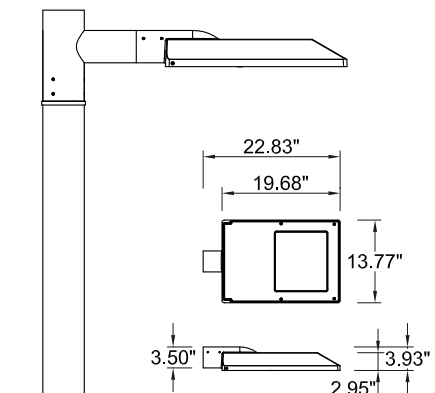
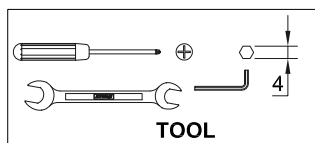

USE-90001

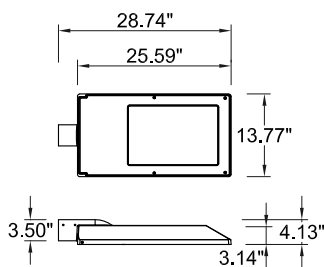

USE-90011

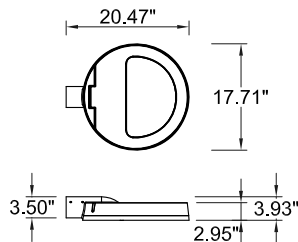

USE-90021

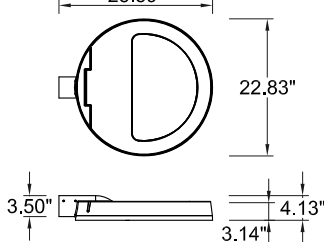

USE-90031

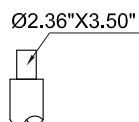

Tenon Post Top
For Accessories
A91060, A91160
A91260, A91360
A91660, A91760

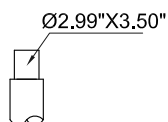

Tenon Post Top
For Accessories
A91460, A91560

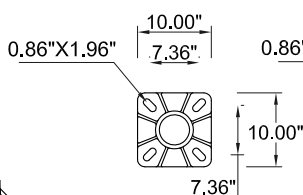

Steel post
Mounting detail

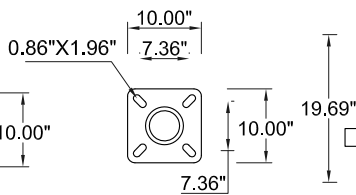

Aluminium post top
Mounting detail

ACCESSORIES

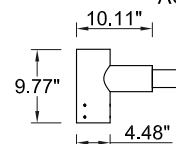

A91060
Single arm mount

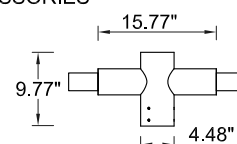

A91160
Double arm mount

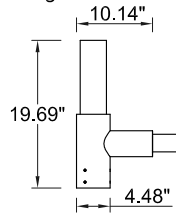

A91060
Single arm mount

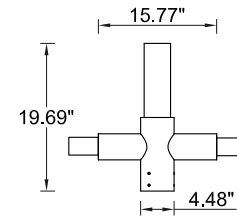

A91160
Double arm mount

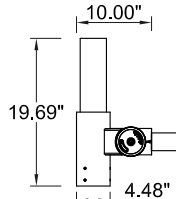

A91660
Single adjustable 60° arm
mount

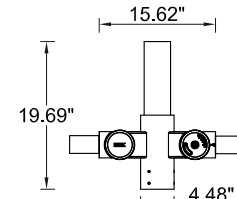

A91760
Single adjustable 60° arm
mount

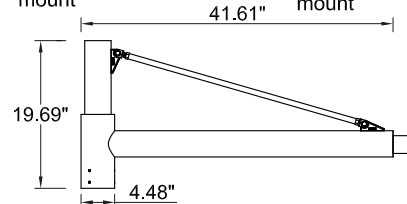

A91460
Single arm mount

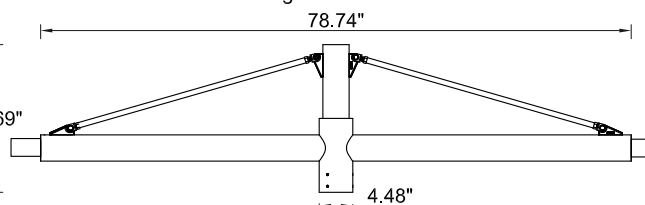

A91560
Double arm mount

Notice to installer :

- 1.WIRING INSTRUCTIONS** Warning : RISK OF FIRE AND ELECTRICAL SHOCK. : FIXTURE MUST BE INSTALLED BY A QUALIFIED ELECTRICIAN ONLY>FIXTURE IS INTENDED FOR INSTALLATION IN ACCORDANCE WITH THE NATIONAL ELECTRICAL CODE, LOCAL AND FEDERAL CODE SPECIFICATIONS. DISCONNECT POWER BEFORE SERVICING.
- 2.This fixture has a VOLTAGE SPECIFIC BALLAST,Check that the supply voltage is the same as the installed ballast voltage.**

Ligman Lighting USA

7144 NW Progress Court, Hillsboro
Oregon, 97124, USA
Tel : 503 645 0500 | Fax : 503 645 8100

www.ligmanlightingusa.com

USE-90001 1/12/17/REV.0 WE
1/3



FM-TS-13/25-05-2007-REV.2

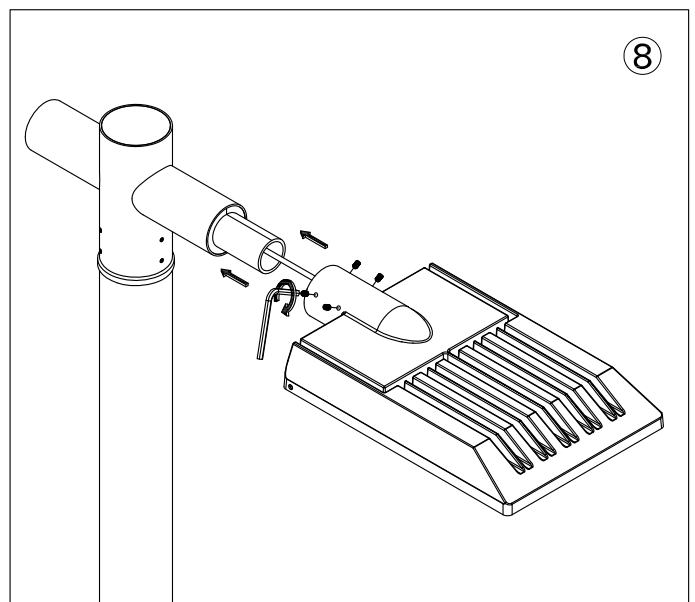
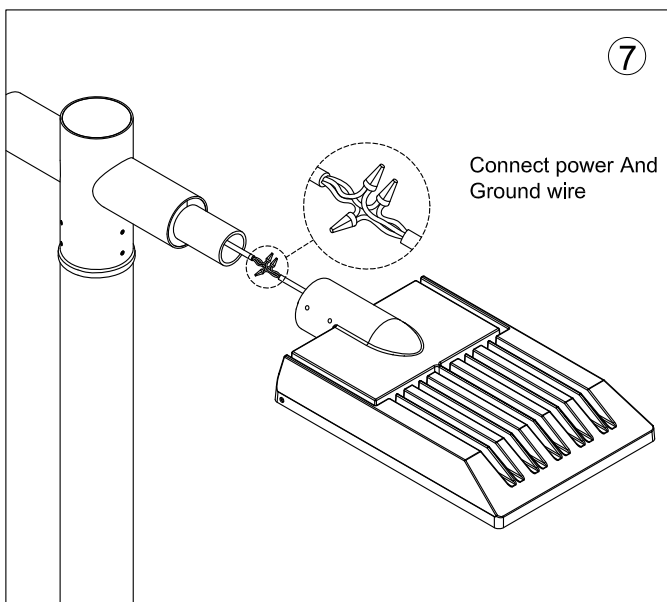
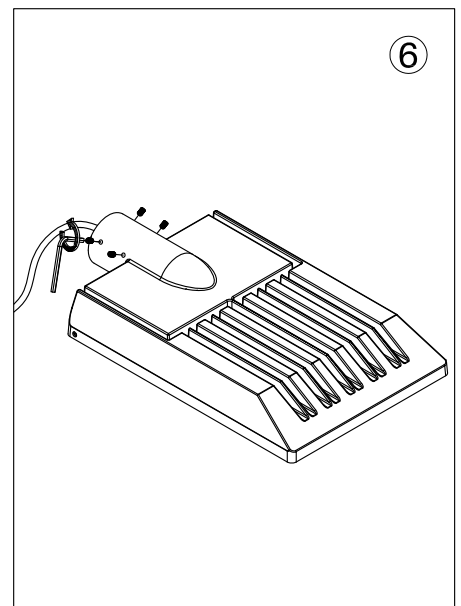
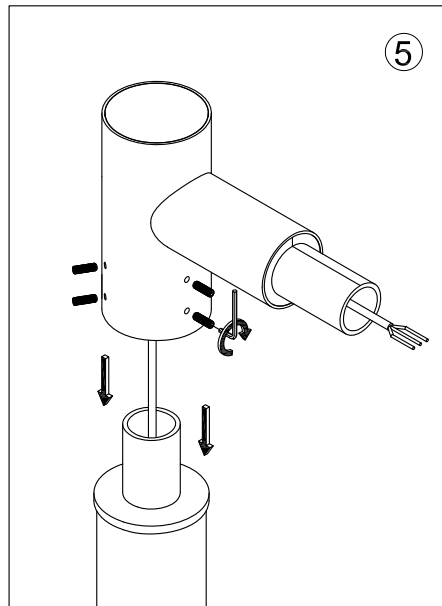
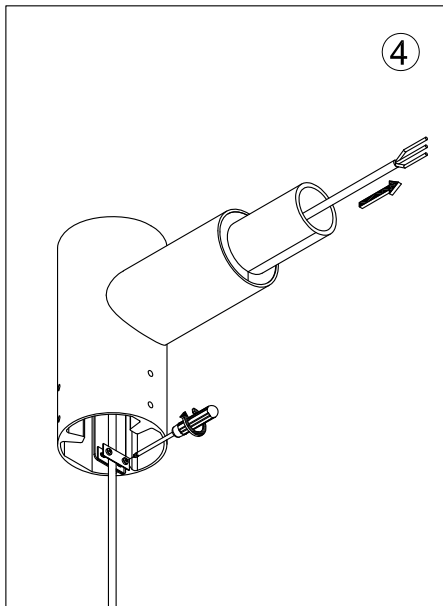
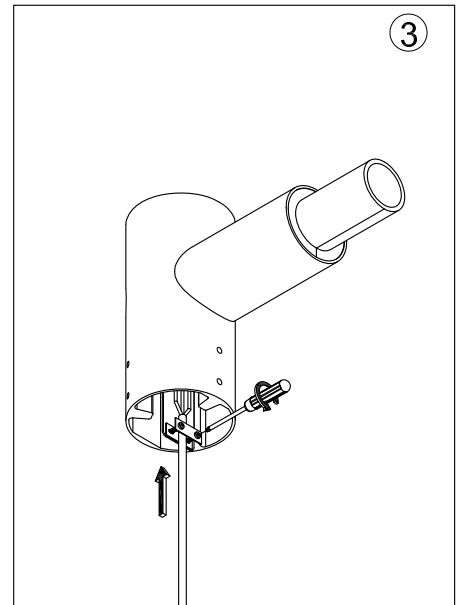
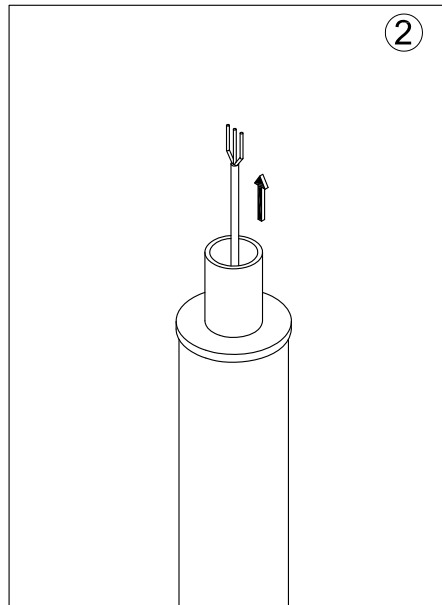
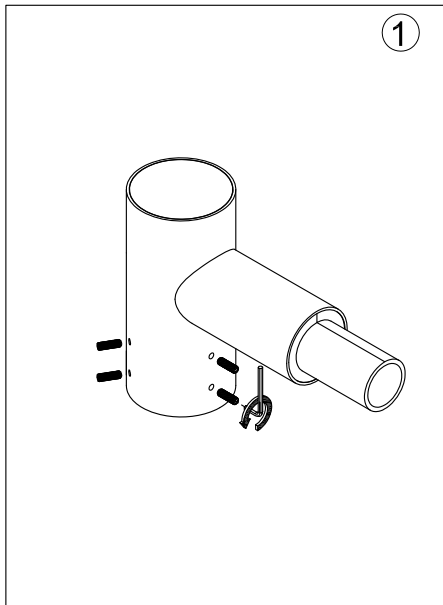

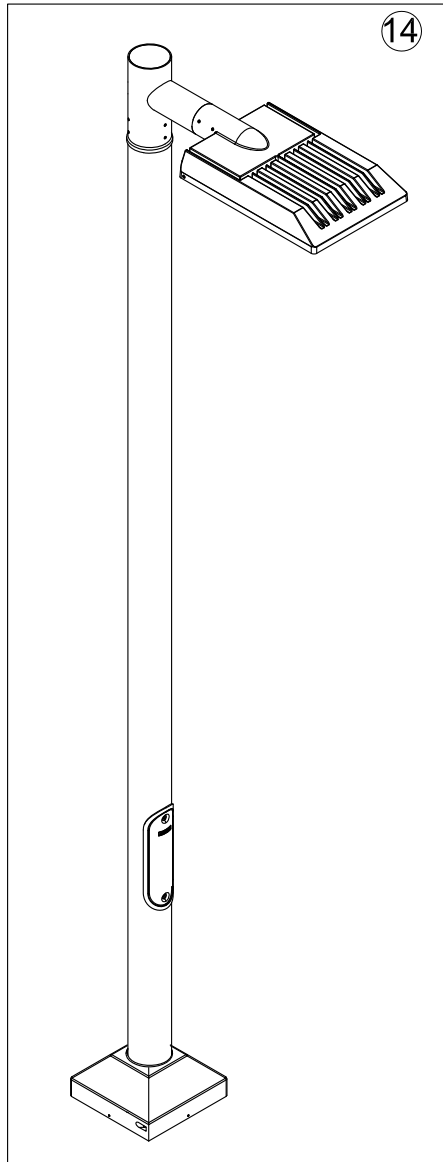
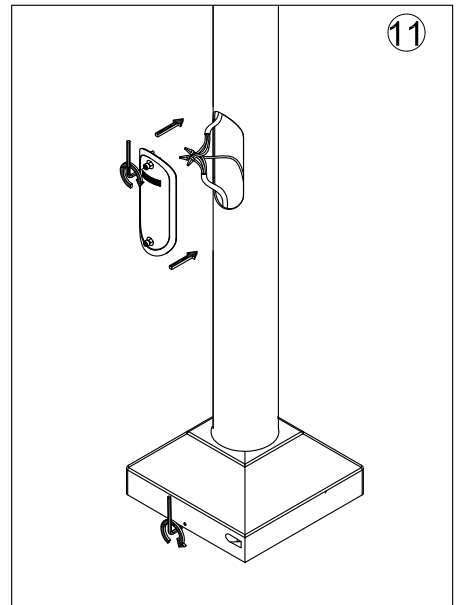
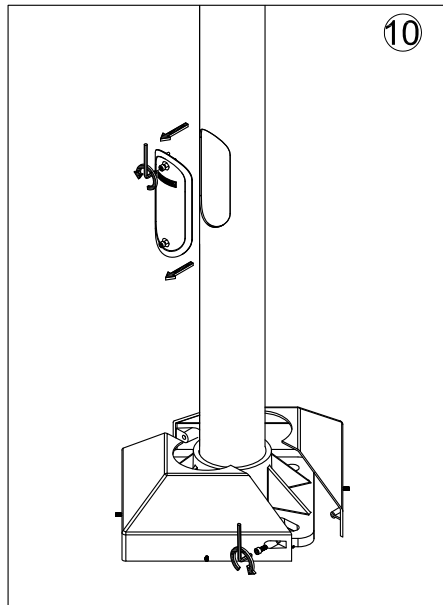
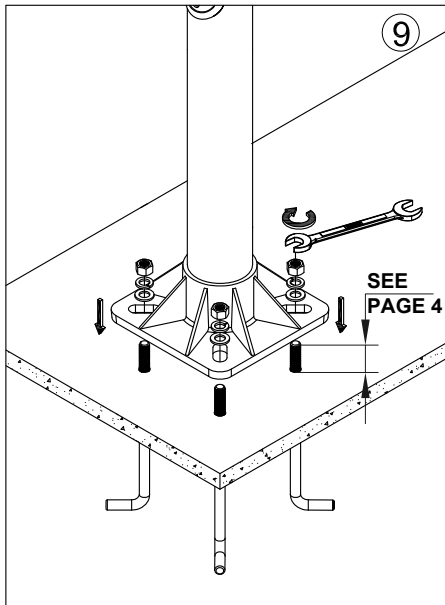

USING LEVELING SHIMS

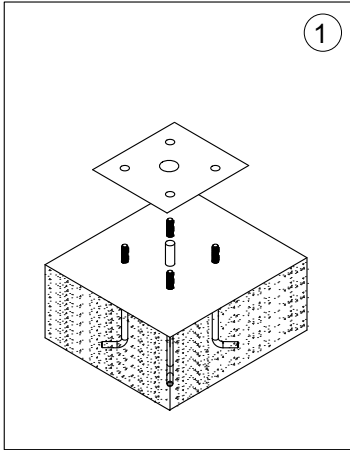

Use anchor bolt template to set anchor bolts into concrete as per civil engineering instructions.

Ligman does not provide foundation details. A local engineer that is familiar with the site soil conditions should provide this information.

NOTE:

Ligman does not recommend using leveling bolts for pole installations.

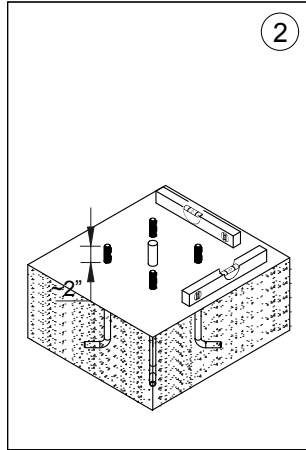

Ensure that the concrete is plumb using a level. Failing to do this will result in pole being uneven or tilted.

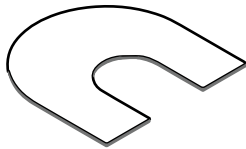

Leveling Shim Example

What's Included Per Pole

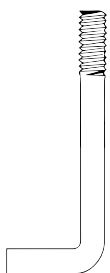

x 4

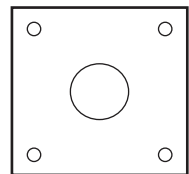
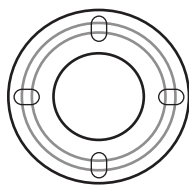

x 4

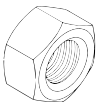

x 4

A single anchor bolt template is provided per pole size to be used for the poles on the project.

Anchor bolt template may be round or square dependant upon which pole is being used.

USING LEVELING BOLTS

SHOULD THE CONTRACTOR SELECT TO USE THE LEVELING BOLT METHOD, AN ADDITIONAL 4 BOLTS NEED TO BE PURCHASED

In rare instances where leveling bolts have to be used, it is important that a flush concrete surface is created to mount the pole base plate.
NOTE: When using leveling bolts, bolt projection should be 3.5"

Using Leveling Bolts Option A

Note : Bolt cover stops flush with the pole base plate 3.5" 4.65" Concrete pad to be provided by contractor after leveling pole

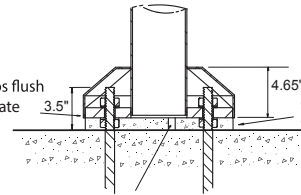

Slot to be provided in concrete to allow water to drain

When using leveling bolts.

After establishing a level platform the space between the original concrete surface and the pole base should be filled with concrete and finished flush.

This provides a uniform load displacement pad for the forces created by wind and luminaire weight

Foundation and Design by Others

Using Leveling Bolts Option B

Note : Bolt cover stops flush with the pole base plate 3.5" 4.65" Concrete pad to be provided by contractor after leveling pole

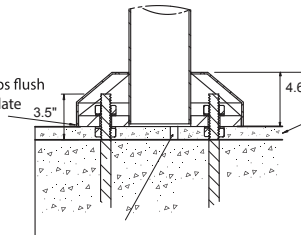

Slot to be provided in concrete to allow water to drain

When using leveling bolts.

After establishing a level platform the space between the original concrete surface and the pole base should be filled with concrete and finished flush.

This provides a uniform load displacement pad for the forces created by wind and luminaire weight