

For installation of Mar 5,6 wall wash light luminaire.  
Model. UMA-30881-30888, UMA-30891-30897.

**Product drawing (dimensions) SUITABLE FOR WET LOCATIONS**

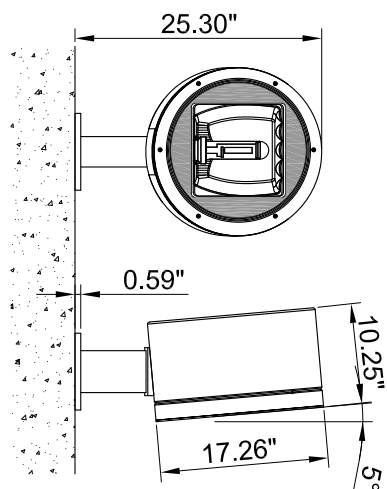

UMA-30881-UMA-30888

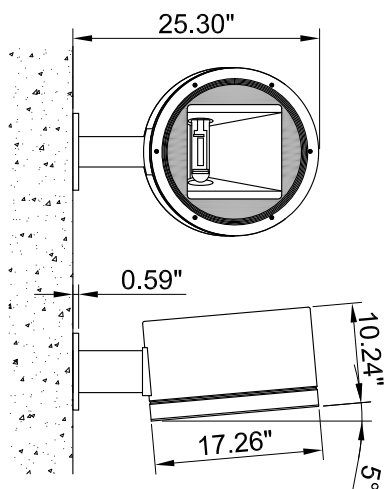

UMA-30891-UMA-30897

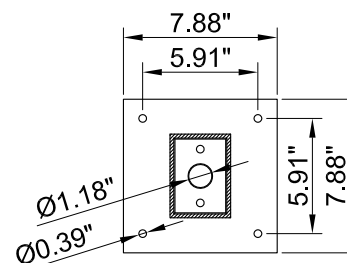
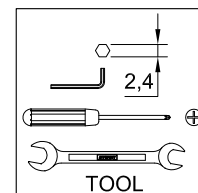

MOUNTING DETAIL

**NOTE**

Mounts over  
a 3"Octagonal  
Junction box.

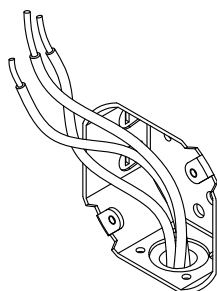

①

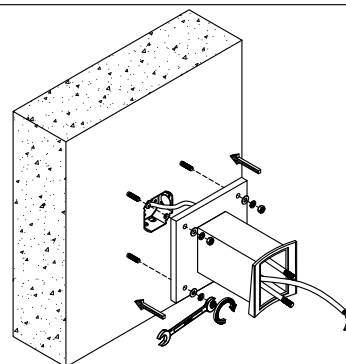

②

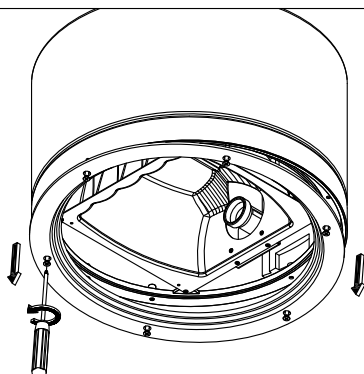

③

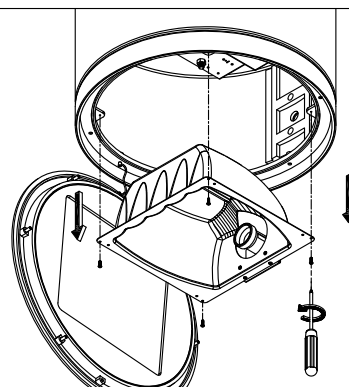

④

**Notice to installer :**

- 1.WIRING INSTRUCTIONS** Warning : RISK OF FIRE AND ELECTRICAL SHOCK. : FIXTURE MUST BE INSTALLED BY A QUALIFIED ELECTRICIAN ONLY>FIXTURE IS INTENDED FOR INSTALLATION IN ACCORDANCE WITH THE NATIONAL ELECTRICAL CODE, LOCAL AND FEDERAL CODE SPECIFICATIONS. DISCONNECT POWER BEFORE SERVICING.
- 2.This fixture has a VOLTAGE SPECIFIC BALLAST,Check that the supply voltage is the same as the installed ballast voltage.**

**Ligman Lighting USA**

7144 NW Progress Court, Hillsboro  
Oregon, 97124, USA  
Tel : 503 645 0500 | Fax : 503 645 8100

[www.ligmanlightingusa.com](http://www.ligmanlightingusa.com)

UMA-30881/23/07/14/REV.0

1/2



FM-TS-13/25-05-2007-REV.2

