

INSTALLATION AND SERVICE MANUAL

For Installation of Odessa 17,18 surface exterior downlight LED.
Model. UOD-80021,UOD-80022,UOD-80023,UOD-80024,UOD-80031 and UOD-80033.

Product drawing (dimensions)

IP66 IK08 CLASS I

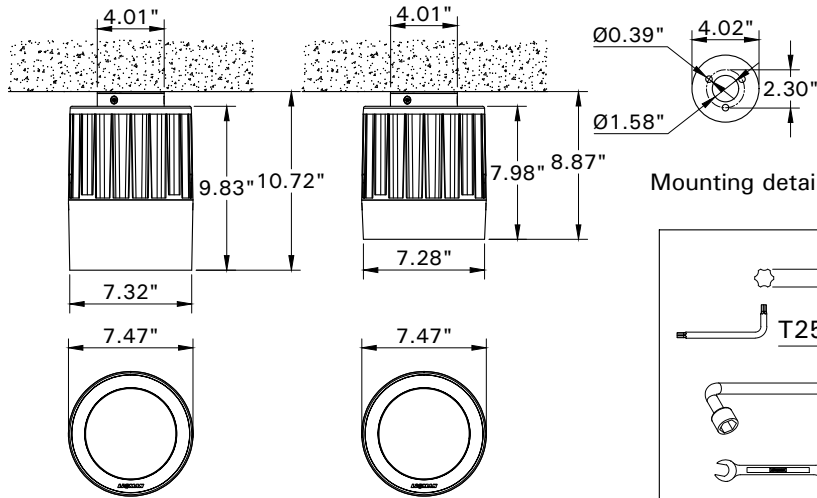

UOD-80021,UOD-80022
UOD-80023,UOD-80024

UOD-80031,UOD-80033

TOOL

1

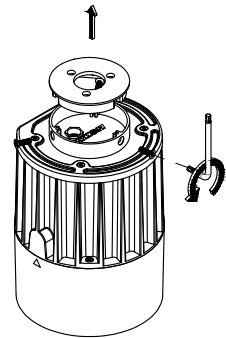

2

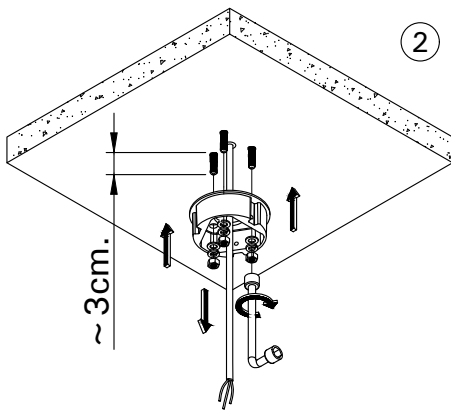

3

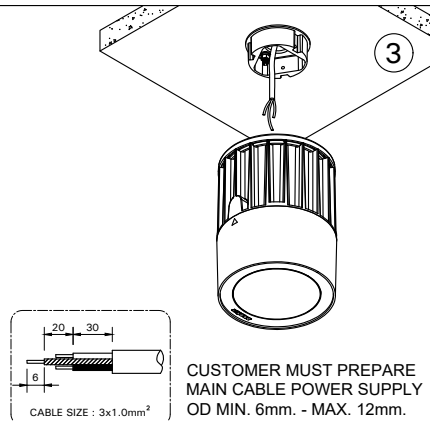

4

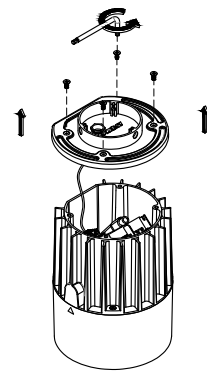

5

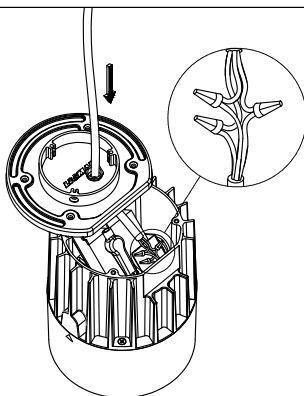

6

Torque : 3.0Nm.

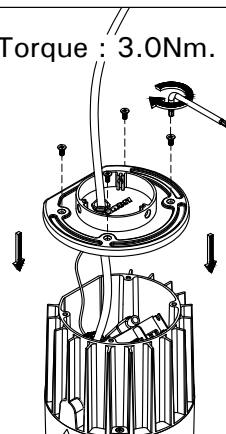

7

Torque : 2.5Nm.

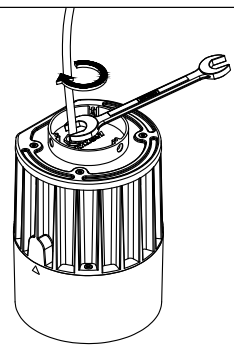

- LIGMAN standard products are supplied with the control gear 24Vdc.
The control gear for other voltages and frequencies is available upon request, please consult us for more details.
- LIGMAN luminaires are designed to conform IEC 60598 2-18 standard.
Technical amendments and modifications techniques reserved.

Ligman Lighting USA

7144 NE Progress Court, Hillsboro
Oregon, 97124, USA
Tel : 503 645 0500 | Fax : 503 645 8100

Torque : 4.3Nm.

8

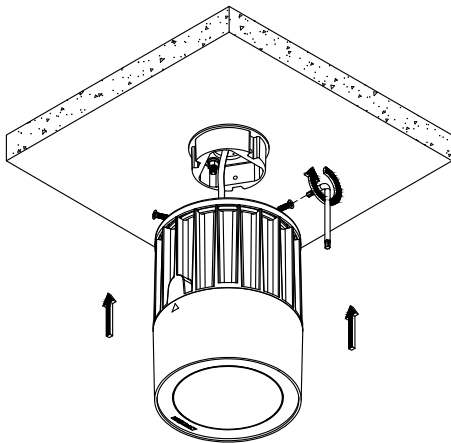

9

