

For installation of Tango wall surface luminaire LED
Model. UTA-31882, UTA-91892.

Product drawing (dimensions) SUITABLE FOR WET LOCATIONS

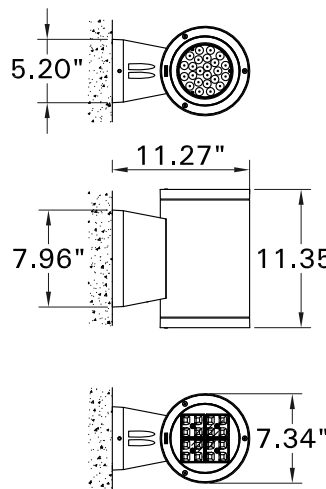

UTA-31882

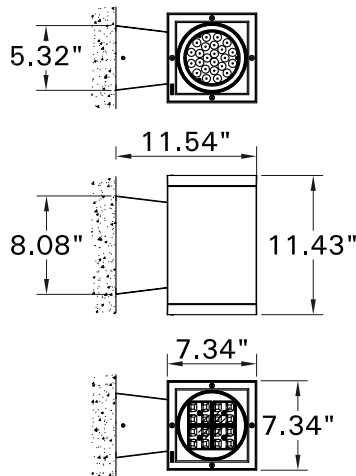

UTA-31892

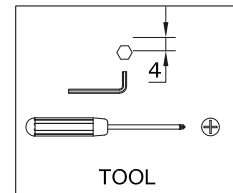

TOOL

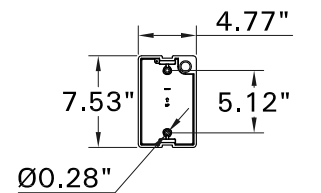

MOUNTING DETAIL

NOTE

Mounts over
a 3" Octagonal
Junction box.

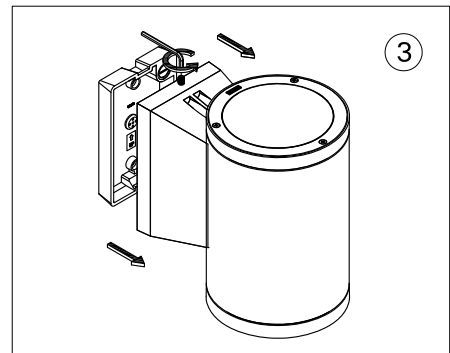
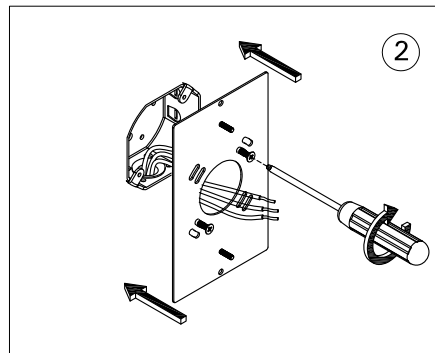
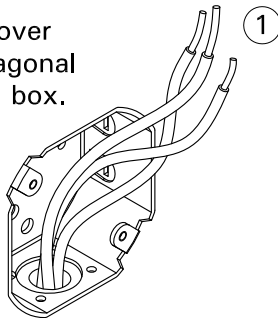

Using the nylon washers
and the 7mm. nut driver
secure the back
plate to the wall

UP

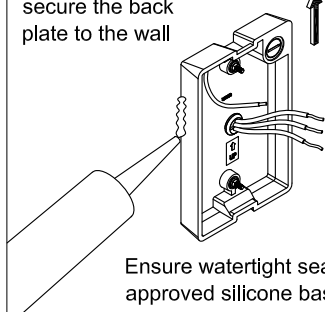

Ensure watertight seal using UL
approved silicone based sealant.

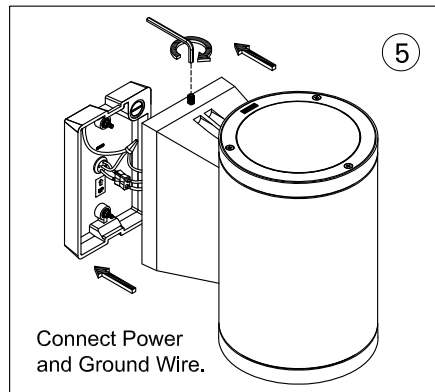

Connect Power
and Ground Wire.

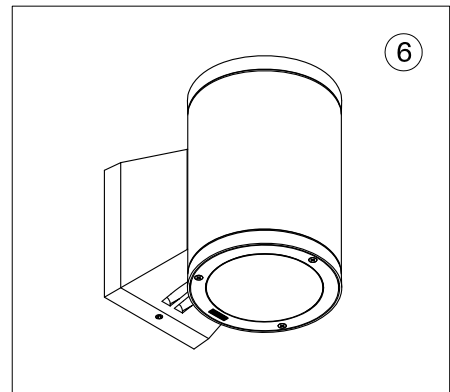

Notice to installer :

1. **WIRING INSTRUCTIONS** Warning : RISK OF FIRE AND ELECTRICAL SHOCK. : FIXTURE MUST BE INSTALLED BY A QUALIFIED ELECTRICIAN ONLY>FIXTURE IS INTENDED FOR INSTALLATION IN ACCORDANCE WITH THE NATIONAL ELECTRICAL CODE, LOCAL AND FEDERAL CODE SPECIFICATIONS. DISCONNECT POWER BEFORE SERVICING.
2. This fixture has a **VOLTAGE SPECIFIC BALLAST**, Check that the supply voltage is the same as the installed ballast voltage.

Ligman Lighting USA

7144 NW Progress Court, Hillsboro
Oregon, 97124, USA
Tel : 503 645 0500 | Fax : 503 645 8100

www.ligmanlightingusa.com

UTA-31882 15/09/17/REV.0 1/1



FM-TS-13/25-05-2007-REV.2