

For installation of Tango 1,11 cylindrical and square Wall up-down light.
Model. UTA-30402, UTA-30404 and UTA-30721, UTA-30723.

Product drawing (dimensions)

SUITABLE FOR WET LOCATIONS

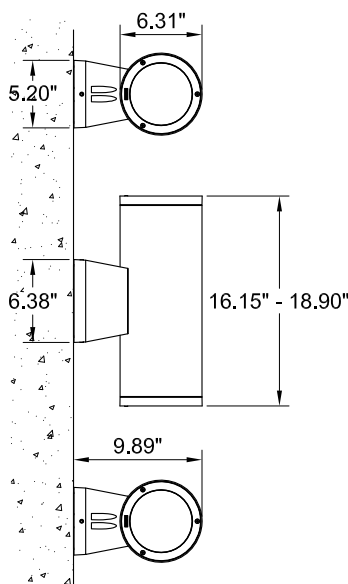

UTA-30402, UTA-30404

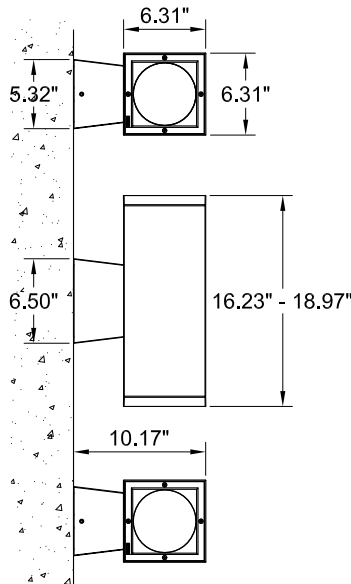

UTA-30721, UTA-30723

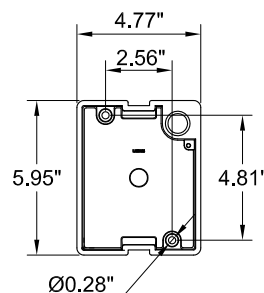

MOUNTING DETAIL

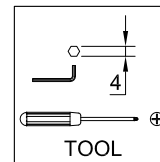

NOTE

Mounts over
a 3" Octagonal
Junction box.

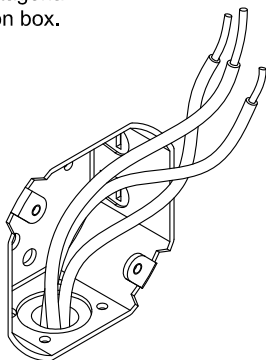

1

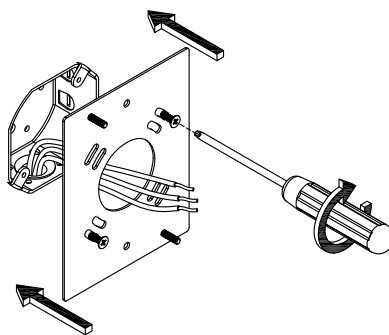

2

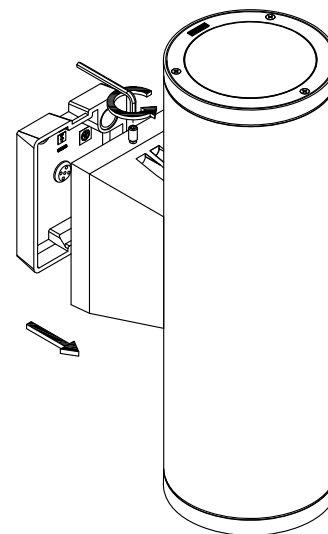

3

Notice to installer :

- 1.WIRING INSTRUCTIONS** Warning : RISK OF FIRE AND ELECTRICAL SHOCK. : FIXTURE MUST BE INSTALLED BY A QUALIFIED ELECTRICIAN ONLY>FIXTURE IS INTENDED FOR INSTALLATION IN ACCORDANCE WITH THE NATIONAL ELECTRICAL CODE, LOCAL AND FEDERAL CODE SPECIFICATIONS. DISCONNECT POWER BEFORE SERVICING.
- 2.This fixture has a VOLTAGE SPECIFIC BALLAST,Check that the supply voltage is the same as the installed ballast voltage.**

Ligman Lighting USA

7144 NW Progress Court, Hillsboro
Oregon, 97124, USA
Tel : 503 645 0500 | Fax : 503 645 8100

www.ligmanlightingusa.com

UTA-30402/13/06/14/REV.1
1/2

ISO 9001
ISO 14001
BUREAU VERITAS
Certification



FM-TS-13/25-05-2007-REV.2

Center the Back Plate over the J Box
and Secure the back plate to the wall

4

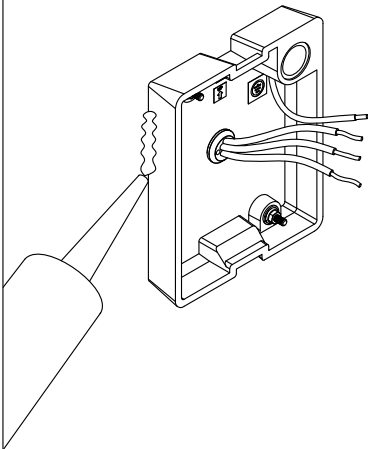

Ensure watertight seal using UL approved
silicone based sealant.

Connect Power
and Ground Wire.

5

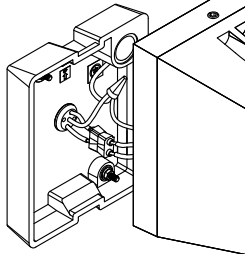

6

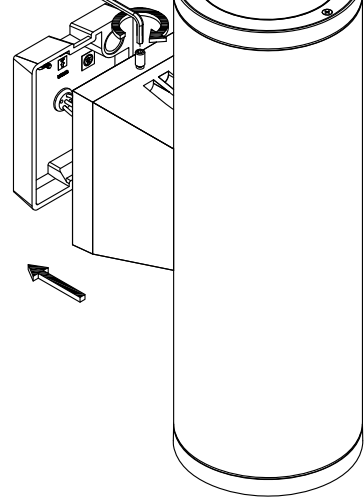

7

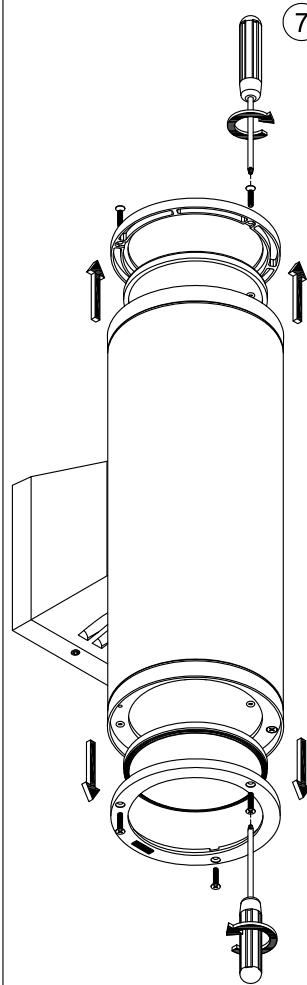

8

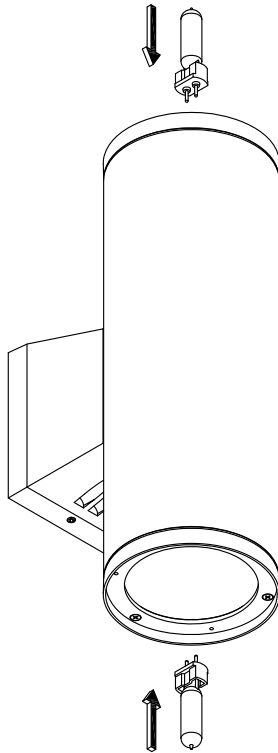

9

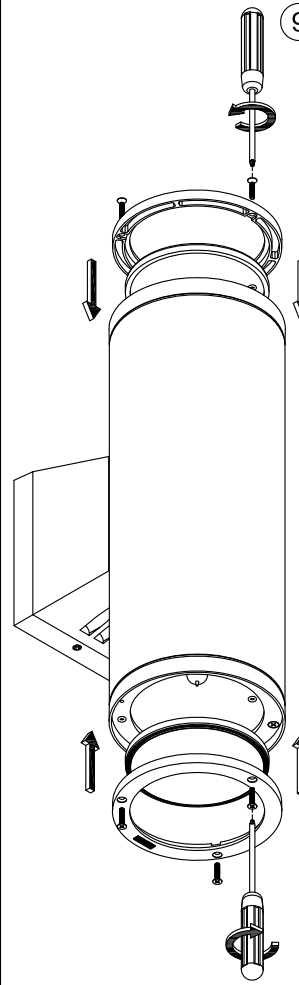

10

