

INSTALLATION AND SERVICE MANUAL

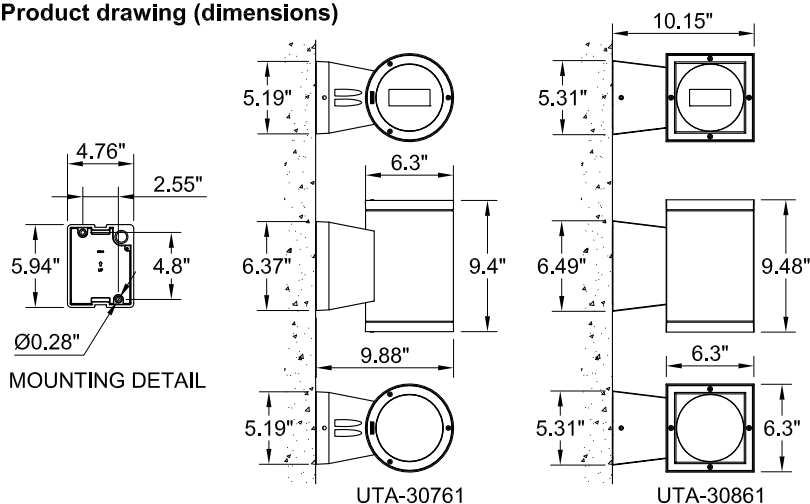

For installation of Tango 7,9 cylindrical and square wall up-down light.
Model. UTA-30761 and UTA-30861.

Product drawing (dimensions)



SUITABLE FOR WET LOCATIONS

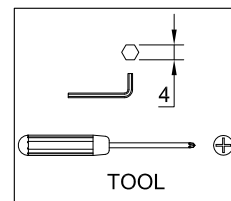
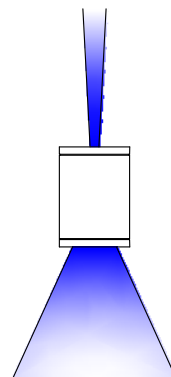

NOTE

Mounts over a 3" Octagonal Junction box.

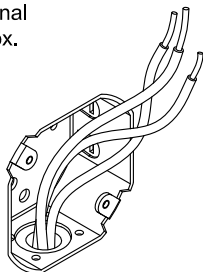

1

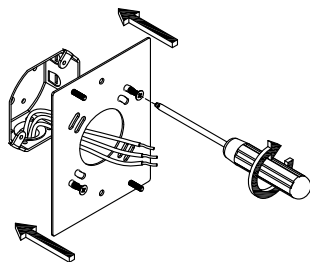

2

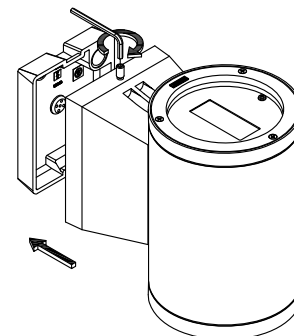

3

Center the Back Plate over the J Box and Secure the back plate to the wall

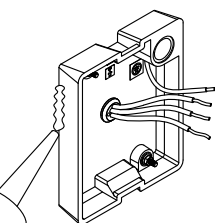

Ensure watertight seal using UL approved silicone based sealant.

4

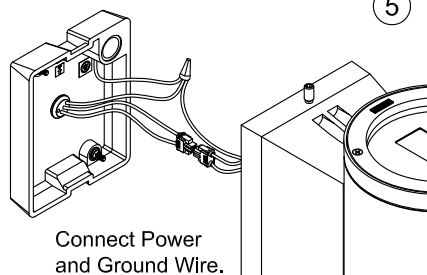

Connect Power and Ground Wire.

5

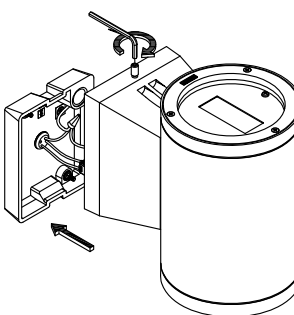

6

Notice to installer :

- 1.WIRING INSTRUCTIONS Warning : RISK OF FIRE AND ELECTRICAL SHOCK. : FIXTURE MUST BE INSTALLED BY A QUALIFIED ELECTRICIAN ONLY>FIXTURE IS INTENDED FOR INSTALLATION IN ACCORDANCE WITH THE NATIONAL ELECTRICAL CODE, LOCAL AND FEDERAL CODE SPECIFICATIONS. DISCONNECT POWER BEFORE SERVICING.**
- 2.This fixture has a VOLTAGE SPECIFIC BALLAST,Check that the supply voltage is the same as the installed ballast voltage.**

Ligman Lighting USA

7144 NW Progress Court, Hillsboro
Oregon, 97124, USA
Tel : 503 645 0500 | Fax : 503 645 8100

www.ligmanlightingusa.com

UTA-30761/04/07/14/REV.0
1/2



FM-TS-13/25-05-2007-REV.2

