

# INSTALLATION AND SERVICE MANUAL



## For installation of Sandy Surface mounted luminaires

Model. USA-30051-56, USA-30061-66, USA-30071-74, USA-30081-84, USA-30091-96, USA-30101-06.

### Product drawing (dimensions) SUITABLE FOR WET LOCATIONS

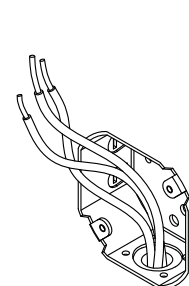
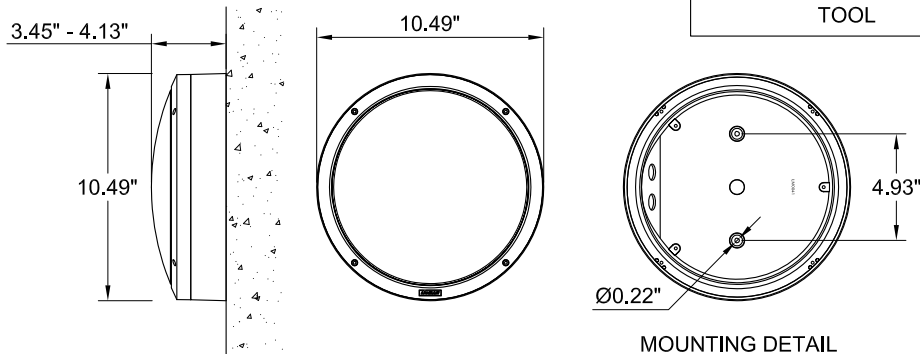

**NOTE** Mounts over a 3\"/>

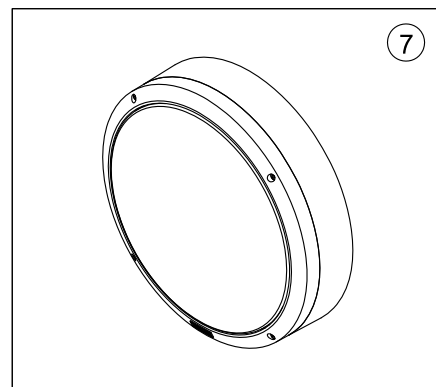
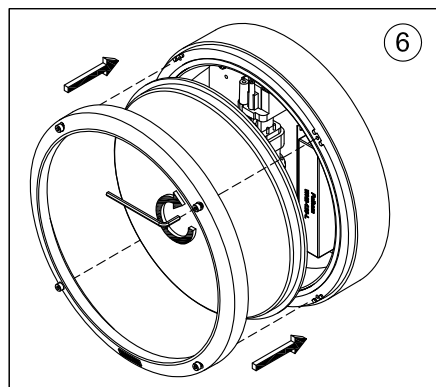
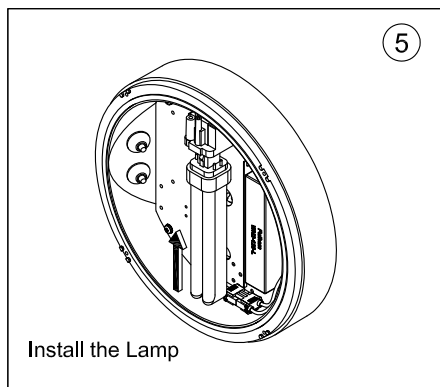
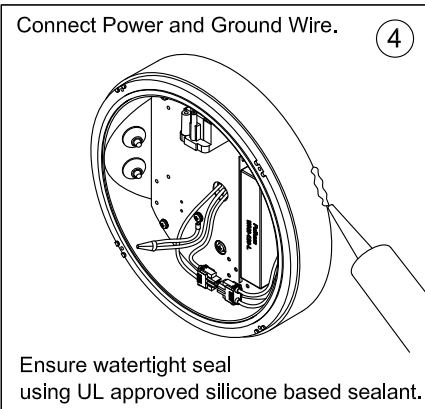
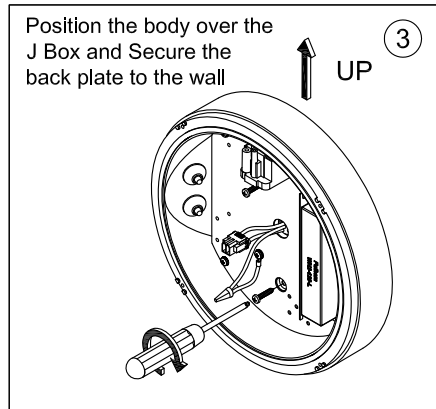
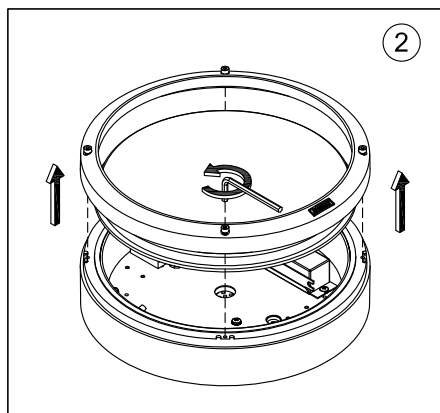

### Notice to installer :

1. **WIRING INSTRUCTIONS** Warning : RISK OF FIRE AND ELECTRICAL SHOCK. : FIXTURE MUST BE INSTALLED BY A QUALIFIED ELECTRICIAN ONLY>FIXTURE IS INTENDED FOR INSTALLATION IN ACCORDANCE WITH THE NATIONAL ELECTRICAL CODE, LOCAL AND FEDERAL CODE SPECIFICATIONS. DISCONNECT POWER BEFORE SERVICING.
2. This fixture has a **VOLTAGE SPECIFIC BALLAST**, Check that the supply voltage is the same as the installed ballast voltage.

Ligman Lighting USA

7144 NW Progress Court, Hillsboro  
Oregon, 97124, USA  
Tel : 503 645 0500 | Fax : 503 645 8100

[www.ligmanlightingusa.com](http://www.ligmanlightingusa.com)

USA-30051/21/09/12/REV.1  
1/1



FM-TS-13/25-05-2007-REV.2