

For installation of Qba wall light.  
Model. UQB-31051-31059 and UQB-31061-31069.

## Product drawing (dimensions)

SUITABLE FOR WET LOCATIONS

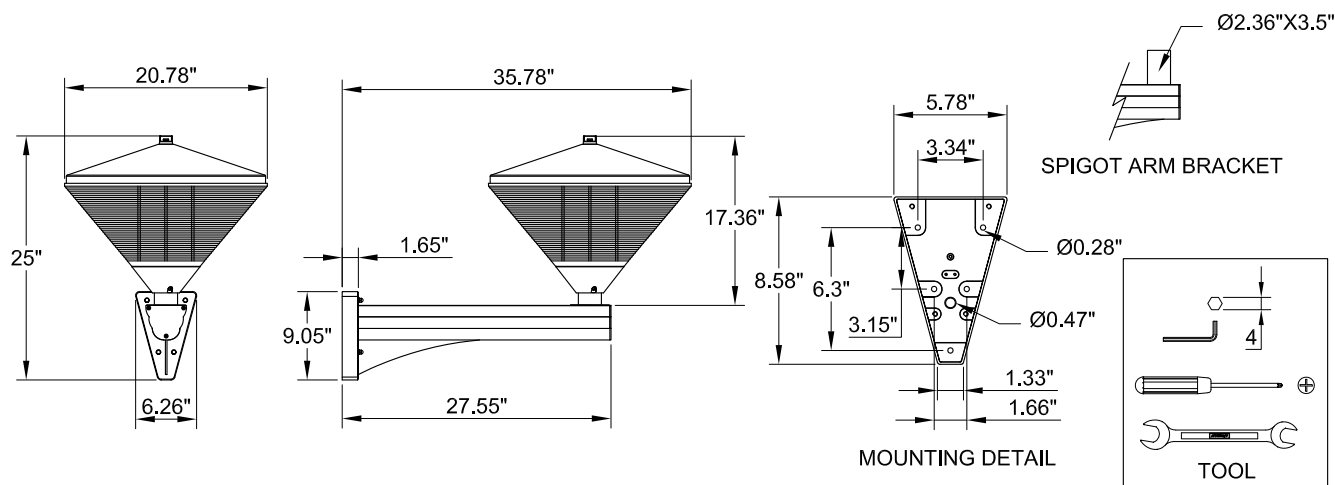

### NOTE

Mounts over  
a 3"Octagonal  
Junction box.

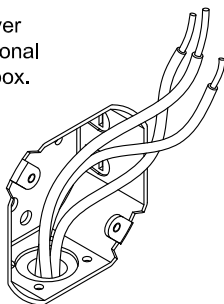

1

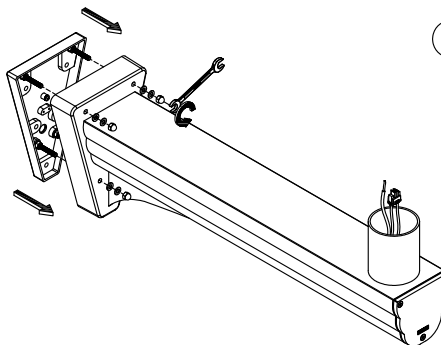

2

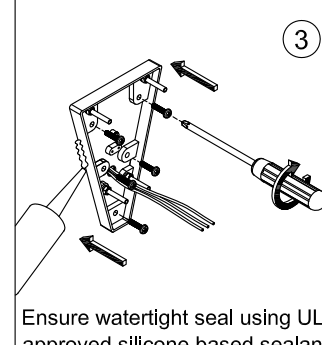

3

Ensure watertight seal using UL  
approved silicone based sealant.

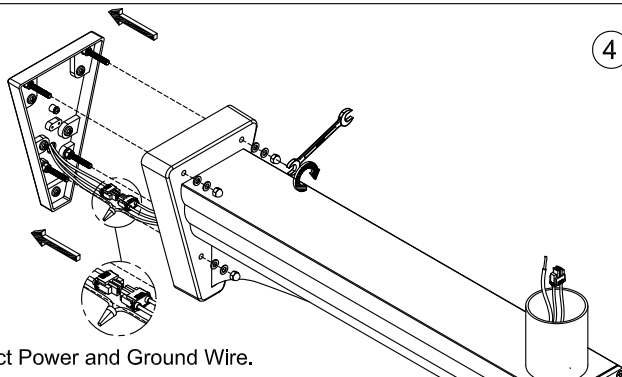

4

Connect Power and Ground Wire.

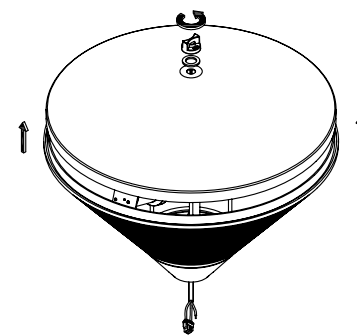

5

### Notice to installer :

- 1.WIRING INSTRUCTIONS** Warning : RISK OF FIRE AND ELECTRICAL SHOCK. : FIXTURE MUST BE INSTALLED BY A QUALIFIED ELECTRICIAN ONLY>FIXTURE IS INTENDED FOR INSTALLATION IN ACCORDANCE WITH THE NATIONAL ELECTRICAL CODE, LOCAL AND FEDERAL CODE SPECIFICATIONS. DISCONNECT POWER BEFORE SERVICING.
- 2.This fixture has a VOLTAGE SPECIFIC BALLAST,Check that the supply voltage is the same as the installed ballast voltage.**

Ligman Lighting USA

7144 NW Progress Court, Hillsboro  
Oregon, 97124, USA  
Tel : 503 645 0500 | Fax : 503 645 8100

www.ligmanlightingusa.com

UQB-31051/27/09/12/REV.0  
1/2



FM-TS-13/25-05-2007-REV.2

