

INSTALLATION AND SERVICE MANUAL

For Installation of Paletta Surface 4.

Product drawing (dlmenslons)

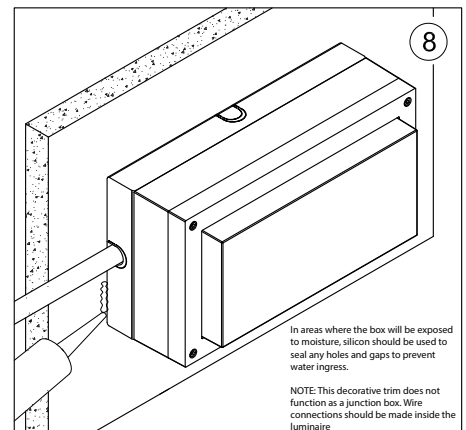
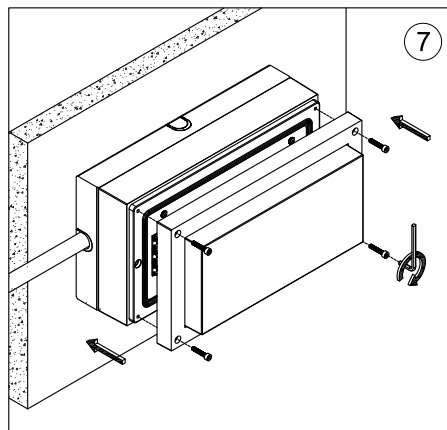
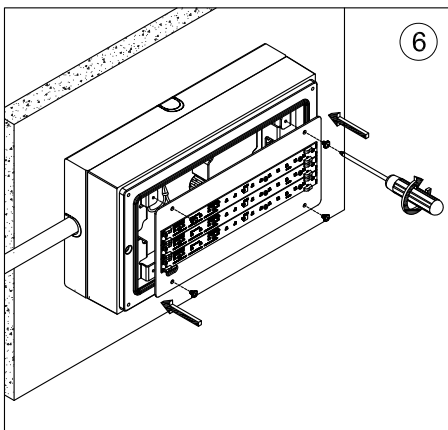
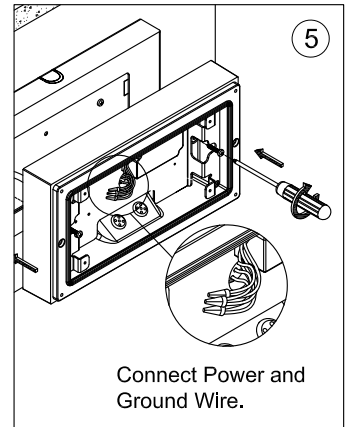
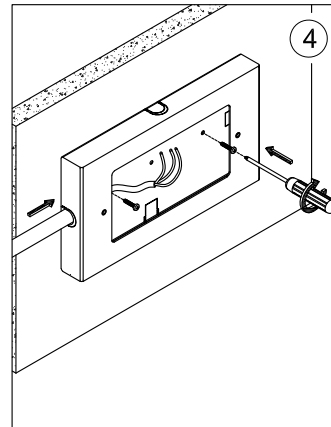
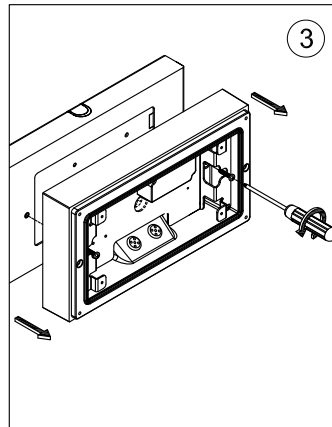
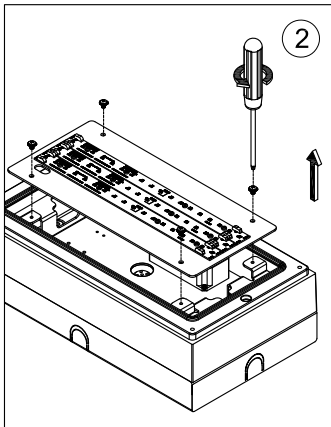
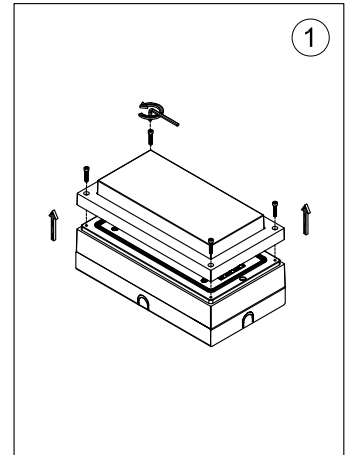
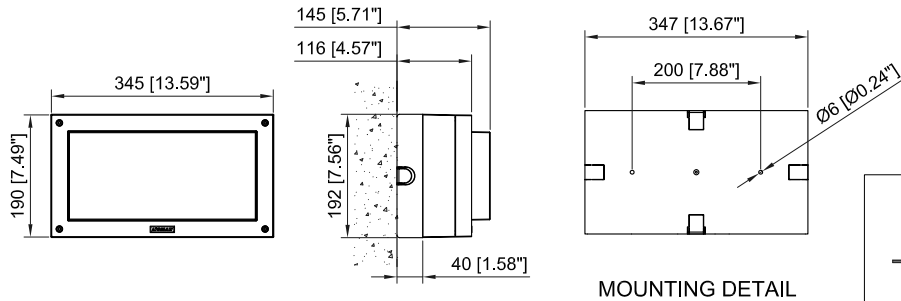

In areas where the box will be exposed to moisture, silicon should be used to seal any holes and gaps to prevent water ingress.

NOTE: This decorative trim does not function as a junction box. Wire connections should be made inside the luminaire.

It is the contractor's responsibility to ensure this trim is installed to local code requirements.

Notice to installer :

- 1.WIRING INSTRUCTIONS** Warning : RISK OF FIRE AND ELECTRICAL SHOCK. : FIXTURE MUST BE INSTALLED BY A QUALIFIED ELECTRICIAN ONLY>FIXTURE IS INTENDED FOR INSTALLATION IN ACCORDANCE WITH THE NATIONAL ELECTRICAL CODE, LOCAL AND FEDERAL CODE SPECIFICATIONS. DISCONNECT POWER BEFORE SERVICING.
- 2.This fixture has a VOLTAGE SPECIFIC BALLAST**,Check that the supply voltage is the same as the installed ballast voltage.

Ligman Lighting USA

7144 NE Progress Court, Hillsboro
Oregon, 97124, USA
Tel : 503 645 0500 | Fax : 503 645 8100

www.ligmanlightingusa.com