

For Installation of Lightsoft 15 bollard. Model. ULH-10671

Product drawing (dimensions)

CE IP65 IK08 CLASS I

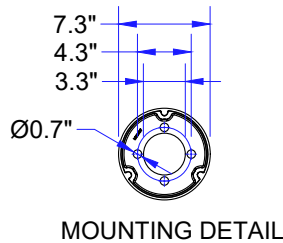
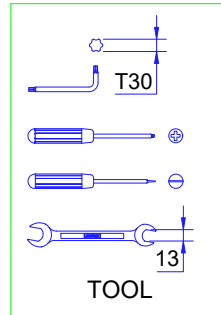
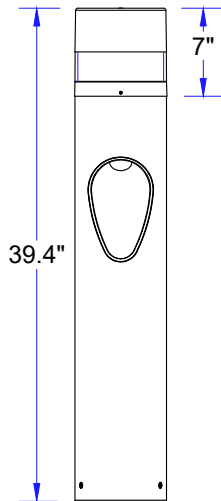
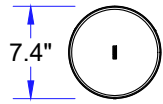

1

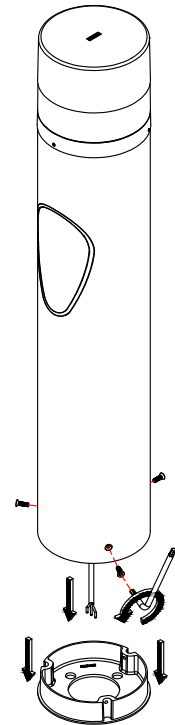

2

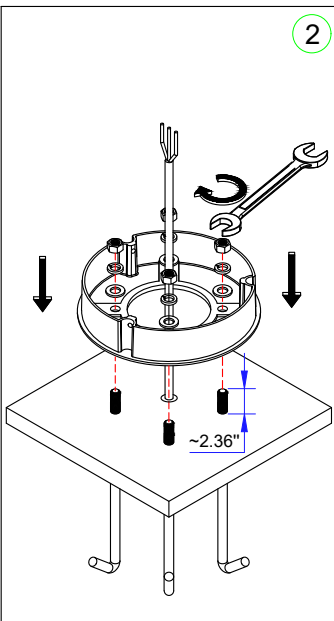

3

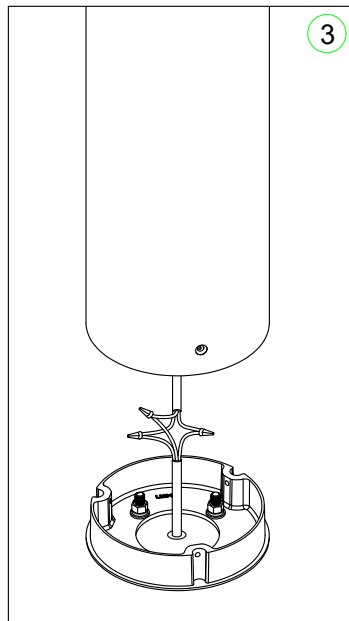

4

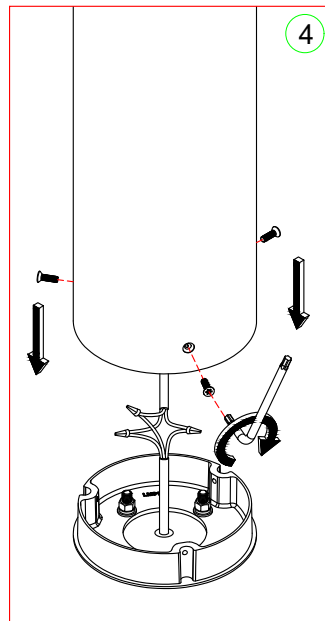

5

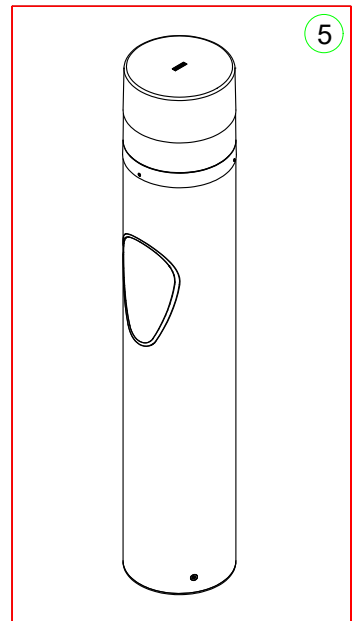

■ LIGMAN standard products are supplied with the control gear 220-240V 50/60Hz.

The control gear for other voltages and frequencies is available upon request, please consult us for more details.

Notice to installer :

1. WIRING INSTRUCTIONS Warning : RISK OF FIRE AND ELECTRICAL SHOCK. : FIXTURE MUST BE INSTALLED BY A QUALIFIED ELECTRICIAN ONLY>FIXTURE IS INTENDED FOR INSTALLATION IN ACCORDANCE WITH THE NATIONAL ELECTRICAL CODE, LOCAL AND FEDERAL CODE SPECIFICATIONS. DISCONNECT POWER BEFORE SERVICING.

2. This fixture has a VOLTAGE SPECIFIC BALLAST, Check that the supply voltage is the same as the installed ballast voltage.

Ligman Lighting USA

7144 NE Progress Court, Hillsboro
Oregon, 97124, USA
Tel : 503 645 0500 | Fax : 503 645 8100

www.ligmanlightingusa.com

ULH10671 26/01/2023 REV.0 RON
1/1

FM-TS-13-2/28-01-2565/Rev.4