

INSTALLATION AND SERVICE MANUAL



For installation of Mini lightsoft wall light COB.
Model. ULH-31146 and ULH-31156.

Product drawing (dimensions)

SUITABLE FOR WET LOCATIONS

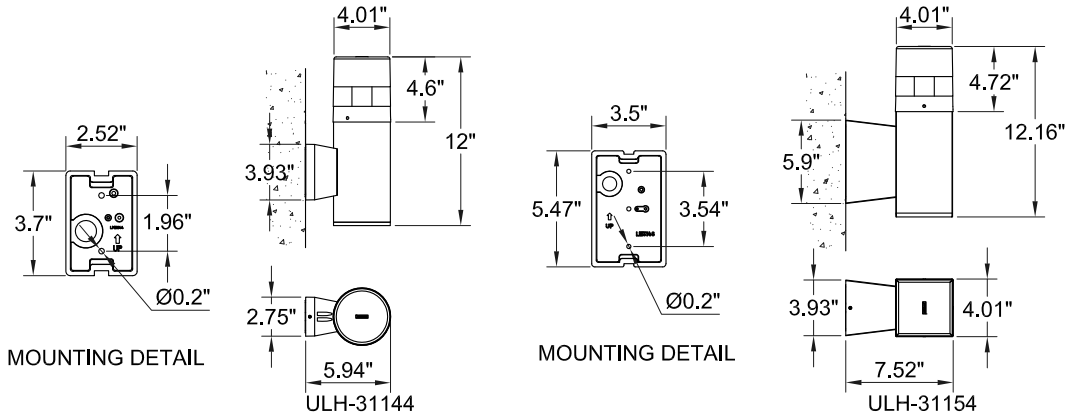

NOTE

Mounts over
a 3"Octagonal
Junction box.

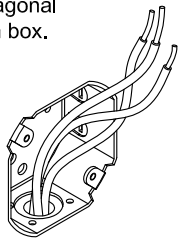

1

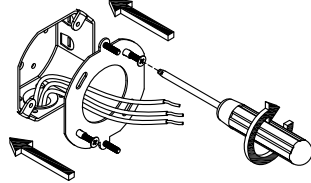

2

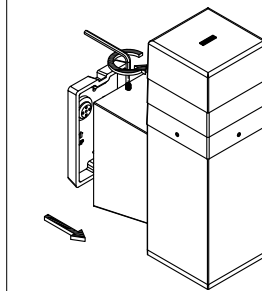

3

Using the nylon washers
and the 7mm. nut driver
secure the back
plate to the wall

Ensure watertight seal using UL
approved silicone based sealant.

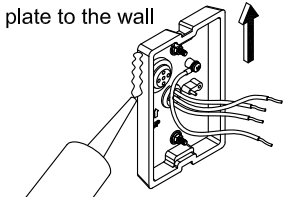

4

Connect Power
and Ground Wire.

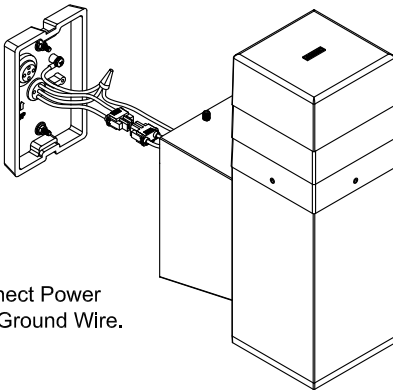

5

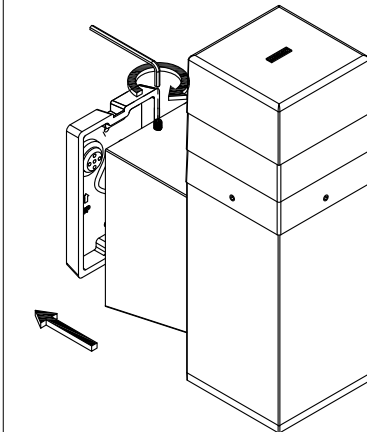

6

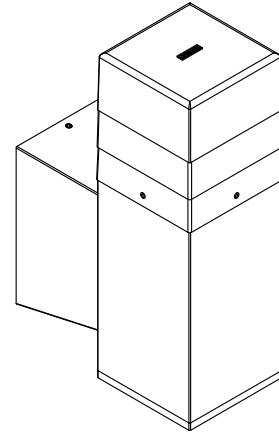

7

Notice to installer :

- 1.WIRING INSTRUCTIONS** Warning : RISK OF FIRE AND ELECTRICAL SHOCK. : FIXTURE MUST BE INSTALLED BY A QUALIFIED ELECTRICIAN ONLY>FIXTURE IS INTENDED FOR INSTALLATION IN ACCORDANCE WITH THE NATIONAL ELECTRICAL CODE, LOCAL AND FEDERAL CODE SPECIFICATIONS. DISCONNECT POWER BEFORE SERVICING.
- 2.This fixture has a VOLTAGE SPECIFIC BALLAST,**Check that the supply voltage is the same as the installed ballast voltage.

Ligman Lighting USA

7144 NW Progress Court, Hillsboro
Oregon, 97124, USA
Tel : 503 645 0500 | Fax : 503 645 8100

www.ligmanlightingusa.com

ULH-31146 22/08/17/REV.0 1/1 KIE



FM-TS-13/25-05-2007-REV.2