

# INSTALLATION AND SERVICE MANUAL

**LIGMAN**  
LIGHTING USA

For installation of Columbus medium shade wall light COB.  
Model. UCO-30166.

Product drawing (dimensions)

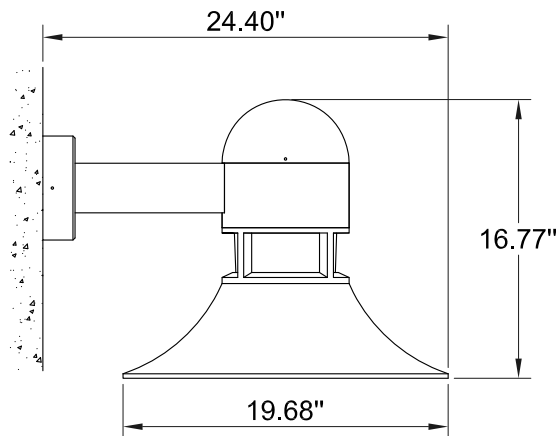

SUITABLE FOR WET LOCATIONS

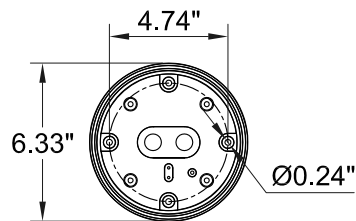

MOUNTING DETAIL

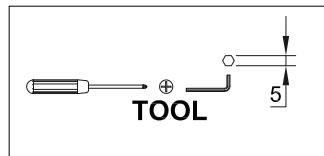

**NOTE**

Mounts over  
a 3"Octagonal  
Junction box.

1

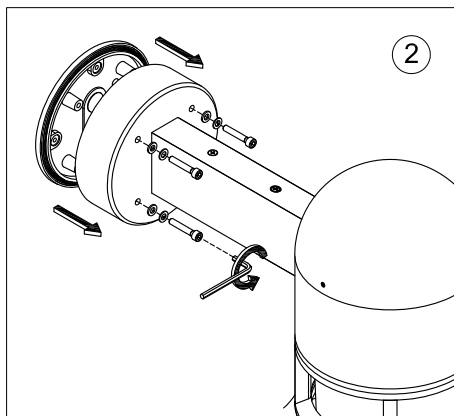
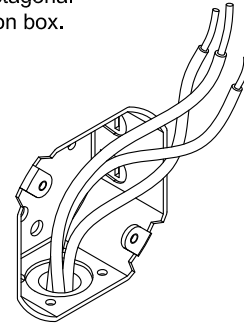

Position the Back Plate  
over the J Box and  
Secure the back  
plate to the wall

3

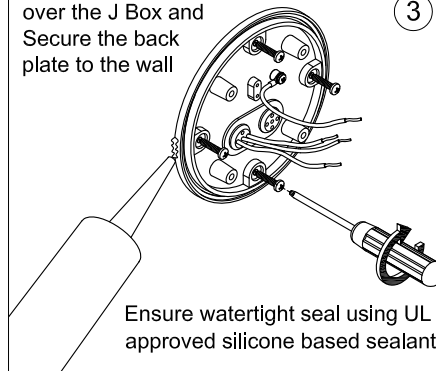

Ensure watertight seal using UL  
approved silicone based sealant.

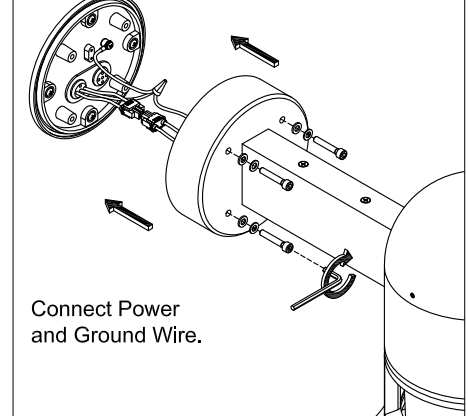

Connect Power  
and Ground Wire.

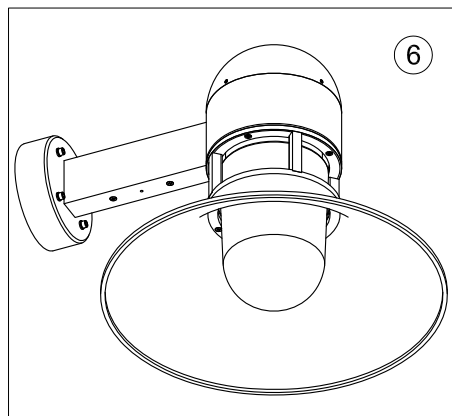
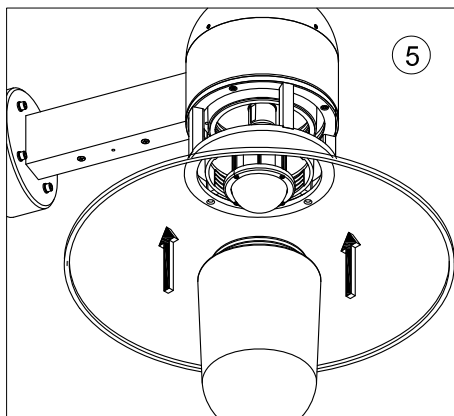

**Notice to installer :**

- 1.WIRING INSTRUCTIONS** Warning : RISK OF FIRE AND ELECTRICAL SHOCK. : FIXTURE MUST BE INSTALLED BY A QUALIFIED ELECTRICIAN ONLY>FIXTURE IS INTENDED FOR INSTALLATION IN ACCORDANCE WITH THE NATIONAL ELECTRICAL CODE, LOCAL AND FEDERAL CODE SPECIFICATIONS. DISCONNECT POWER BEFORE SERVICING.
- 2.This fixture has a VOLTAGE SPECIFIC BALLAST,Check that the supply voltage is the same as the installed ballast voltage.**

**Ligman Lighting USA**

7144 NW Progress Court, Hillsboro  
Oregon, 97124, USA  
Tel : 503 645 0500 | Fax : 503 645 8100

[www.ligmanlightingusa.com](http://www.ligmanlightingusa.com)

UCO-30166 11/09/17 REV.3 1/1



FM-TS-13/25-05-2007-REV.2