

# INSTALLATION AND SERVICE MANUAL

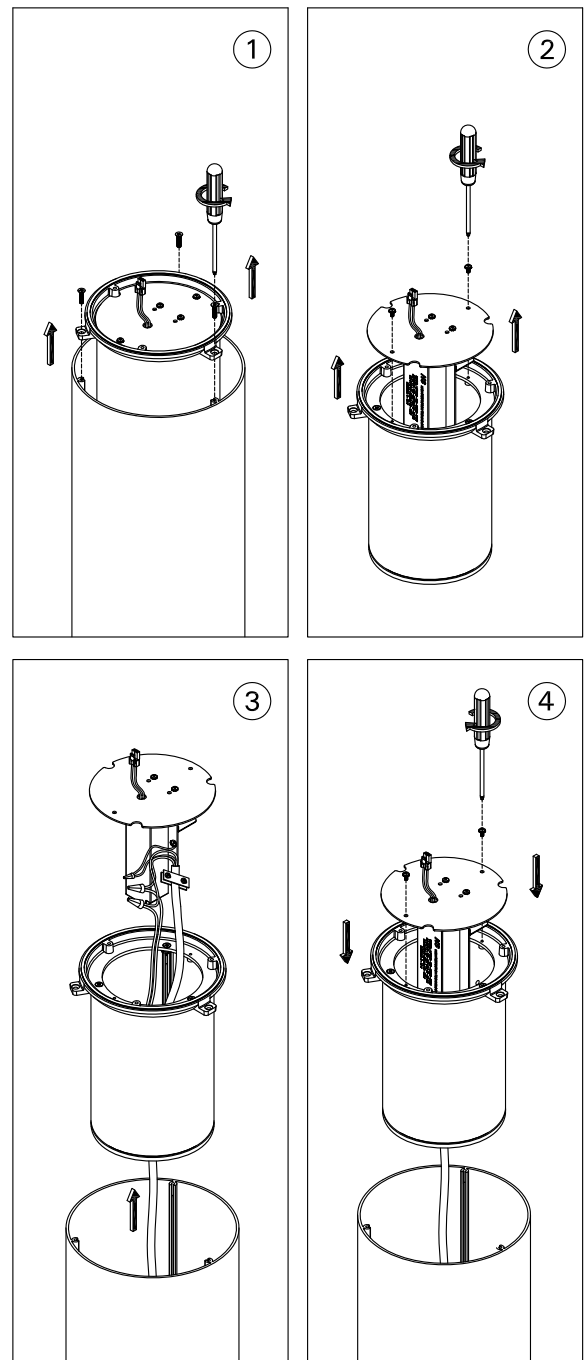

For installation of Large Arizona 2 Light Column dia 225mm. HP LED COB symmetrical.  
Model. UAR-20973-74.

## Product drawing (dimensions) SUITABLE FOR WET LOCATIONS

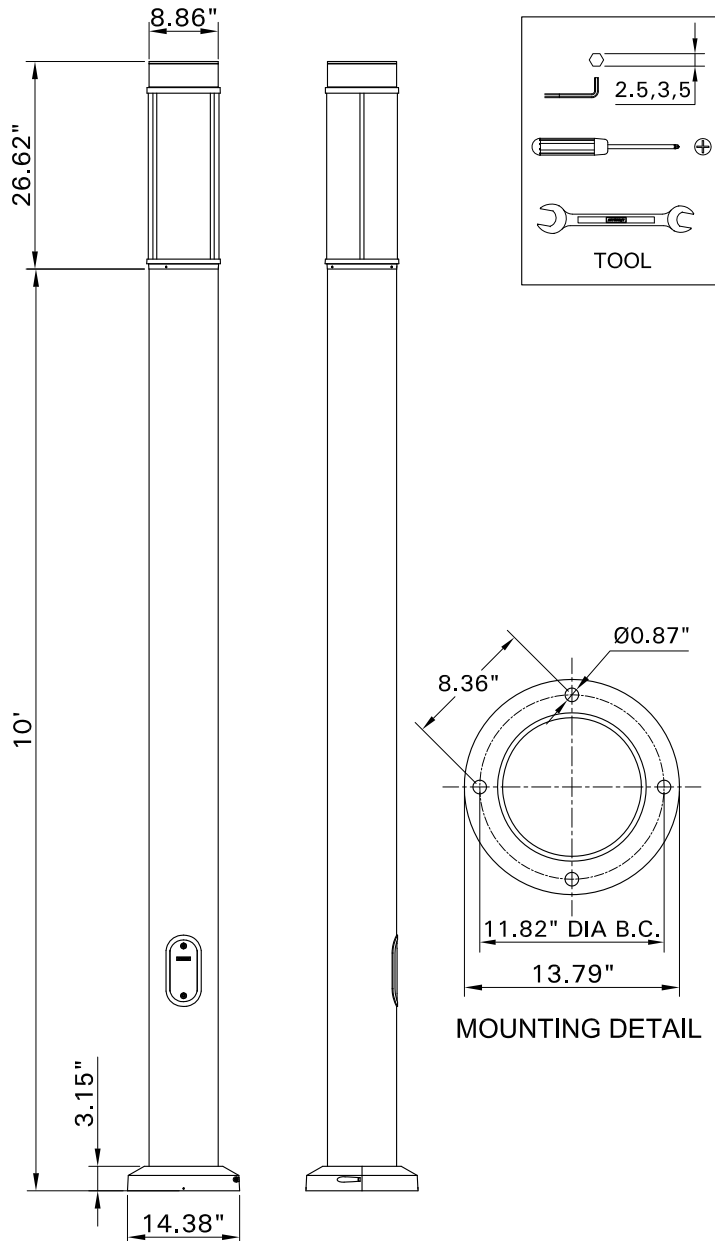

### Notice to installer :

- 1.WIRING INSTRUCTIONS** Warning : RISK OF FIRE AND ELECTRICAL SHOCK. : FIXTURE MUST BE INSTALLED BY A QUALIFIED ELECTRICIAN ONLY>FIXTURE IS INTENDED FOR INSTALLATION IN ACCORDANCE WITH THE NATIONAL ELECTRICAL CODE, LOCAL AND FEDERAL CODE SPECIFICATIONS. DISCONNECT POWER BEFORE SERVICING.
- 2.This fixture has a VOLTAGE SPECIFIC BALLAST,Check that the supply voltage is the same as the installed ballast voltage.**

### Ligman Lighting USA

7144 NW Progress Court, Hillsboro  
Oregon, 97124, USA  
Tel : 503 645 0500 | Fax : 503 645 8100

[www.ligmanlightingusa.com](http://www.ligmanlightingusa.com)

UAR 20973 09/03/16/REV.0  
1/2



FM-TS-13/25-05-2007-REV.2

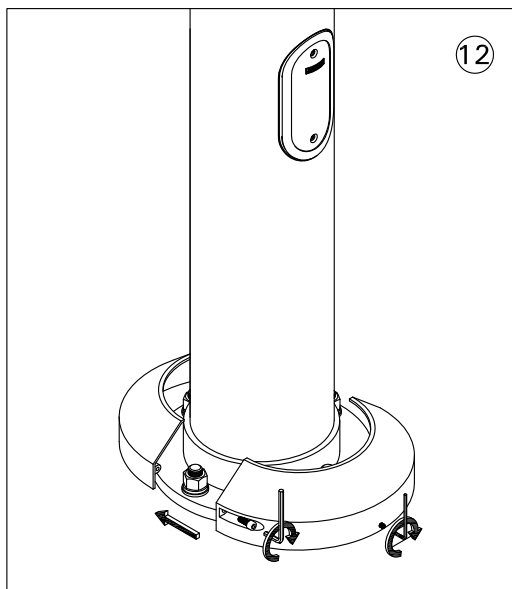
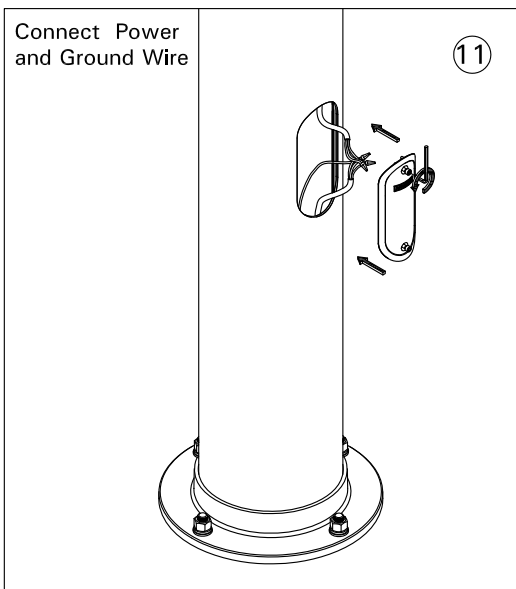
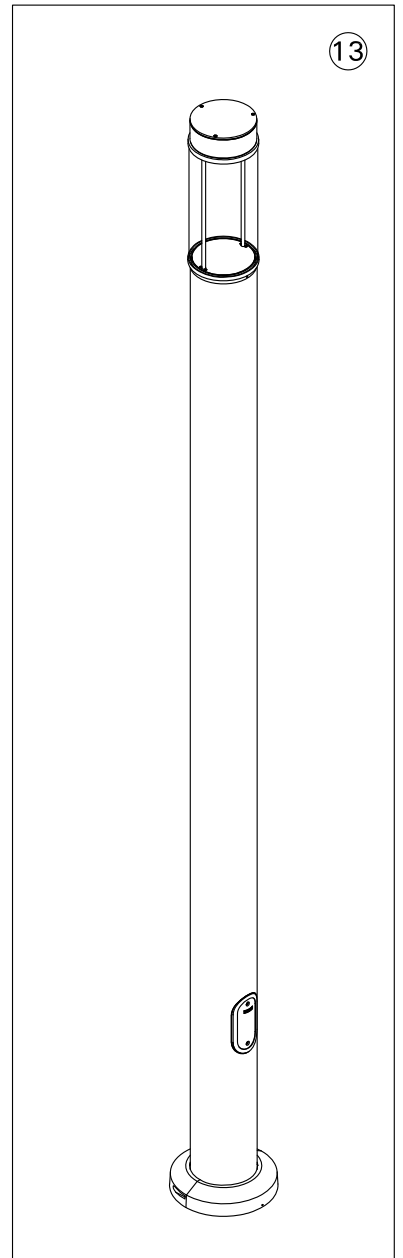
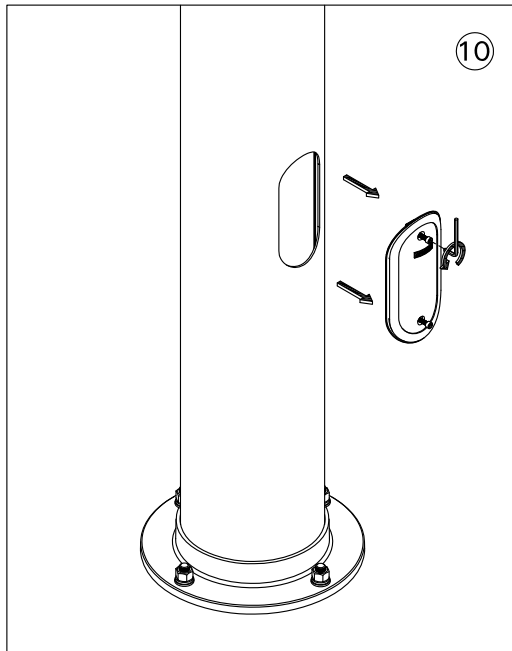
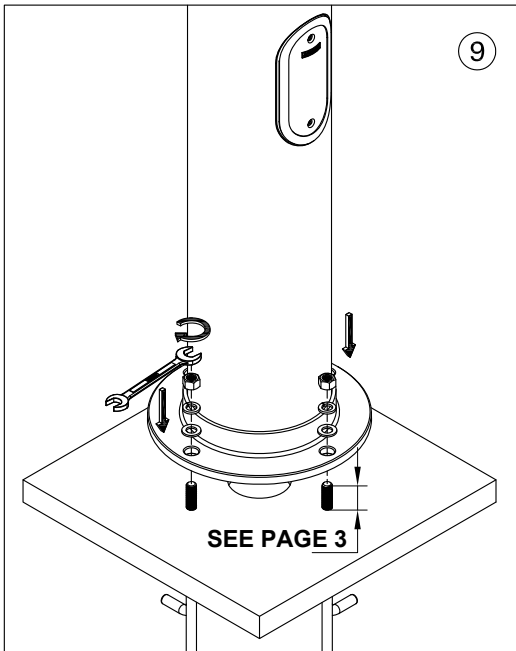
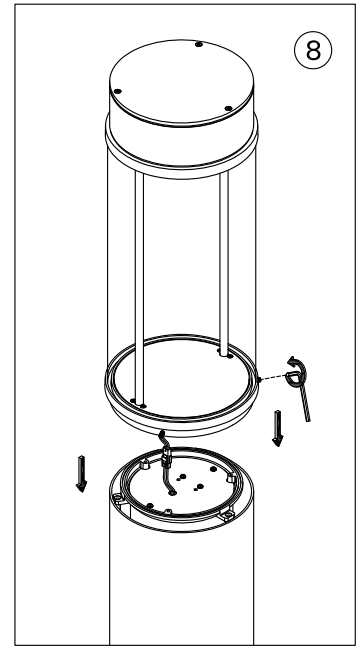
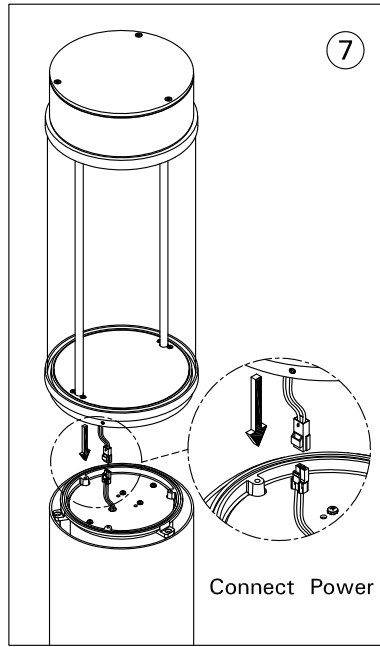
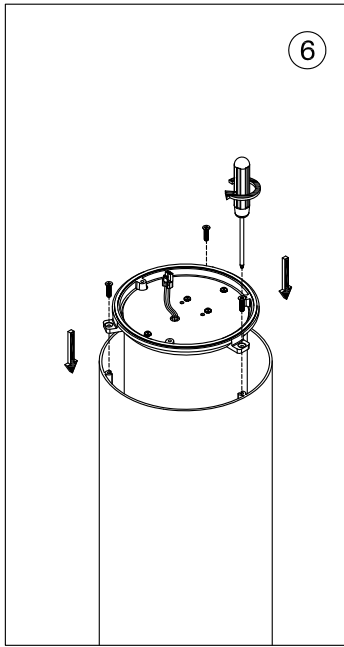
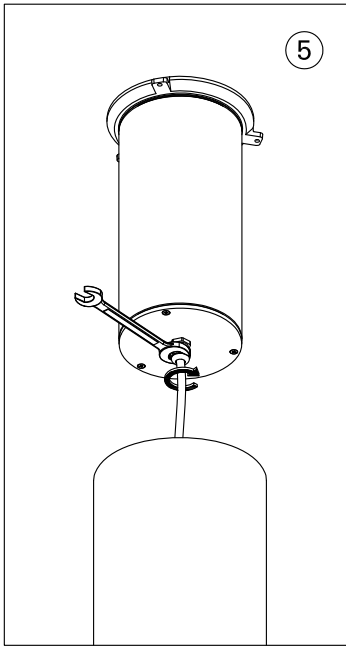

## USING LEVELING SHIMS

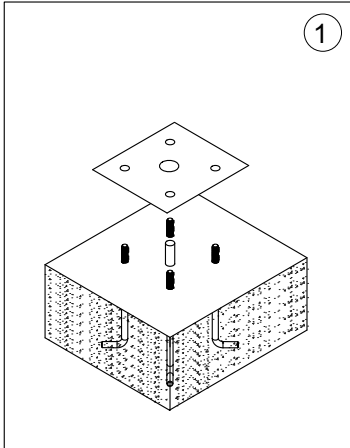

Use anchor bolt template to set anchor bolts into concrete as per civil engineering instructions.

**Ligman does not provide foundation details. A local engineer that is familiar with the site soil conditions should provide this information.**

### NOTE:

Ligman does not recommend using leveling bolts for pole installations.

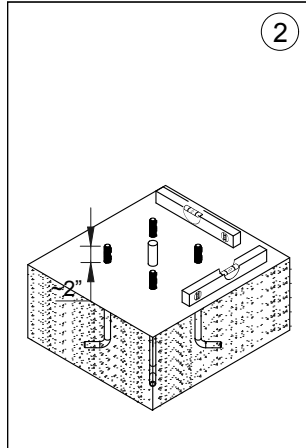

Ensure that the concrete is plumb using a level. Failing to do this will result in pole being uneven or tilted.

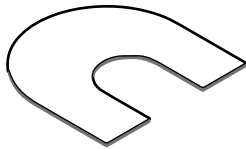

Leveling Shim Example

## What's Included Per Pole



x 4

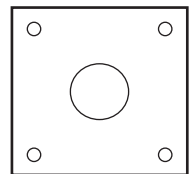
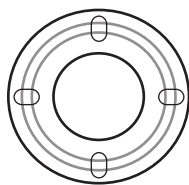

x 4

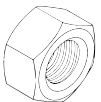

x 4

A single anchor bolt template is provided per pole size to be used for the poles on the project.

Anchor bolt template may be round or square dependant upon which pole is being used.

## USING LEVELING BOLTS

SHOULD THE CONTRACTOR SELECT TO USE THE LEVELING BOLT METHOD, AN ADDITIONAL 4 BOLTS NEED TO BE PURCHASED

In rare instances where leveling bolts have to be used, it is important that a flush concrete surface is created to mount the pole base plate.  
**NOTE: When using leveling bolts, bolt projection should be 3.5"**

### Using Leveling Bolts Option A

Note : Bolt cover stops flush with the pole base plate

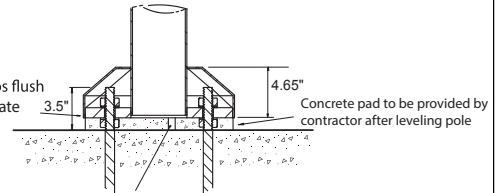

Slot to be provided in concrete to allow water to drain

When using leveling bolts.

After establishing a level platform the space between the original concrete surface and the pole base should be filled with concrete and finished flush.

This provides a uniform load displacement pad for the forces created by wind and luminaire weight

Foundation and Design by Others

### Using Leveling Bolts Option B

Note : Bolt cover stops flush with the pole base plate

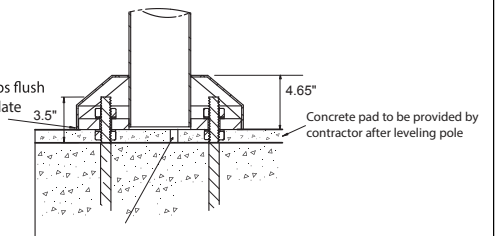

Slot to be provided in concrete to allow water to drain

When using leveling bolts.

After establishing a level platform the space between the original concrete surface and the pole base should be filled with concrete and finished flush.

This provides a uniform load displacement pad for the forces created by wind and luminaire weight