

IP65 : Suitable for Wet Locations
 IK10 : Impact Resistant (Vandal Resistant)



UTA-80401 Tango 5 cylindrical surface exterior downlight LED

A range of cylindrical surface mounted exterior downlight luminaires. Developed for interior and exterior lighting using a variety of different lamp options. These include compact fluorescent lamps, and discharge lamps.

Low copper content die-cast aluminum housing and aluminum bottom frame with integral anti-glare baffles. Stainless steel screws. Durable silicone rubber gasket and clear toughened glass. Single cable entry. Housing is treated with a chemical chroma-tized protection before powder coating, ensuring high corrosion resistance. Integral control gear. Anodized high purity aluminum reflector.

Physical Data

Length: 6.3"
 Height: 10.43"
 Weight: 6.8 lbs

Lamp

30w - 2075lm - White - LED ☺

Beam Angle (Please Specify)

N - Narrow Beam: 14 Deg
 M - Medium Beam: 24 Deg
 W - Wide Beam: 40 Deg

LED Color (Please Specify)

W27 - 2700K
 W30 - 3000K
 W40 - 4000K

Voltage (Please Specify)

120V
 277V
 Other _____

Color (Please Specify)

01-Black - RAL 9011 02- Dark Grey - RAL 7043
 03-White - RAL 9003 04 - Metallic Silver - RAL 9006
 05-Matt Silver - RAL 9006 07- Custom - RAL _____
 06-Bronze - RAL 6014



Lens

F - Frosted Lens
 C - Clear Lens



SCE - Surface Conduit Entry Box - 1/2" Conduit 3/4" Conduit

Mounting Ring

HGT - Specify Custom Height _____ ft

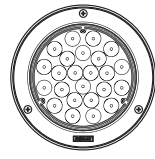
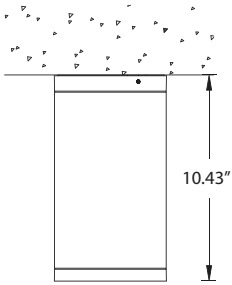
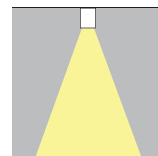

Bottom view
 6.3"

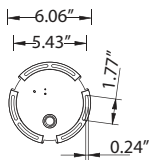

Mounting detail

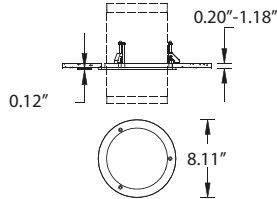

Mounting ring for semi recessed installation



Ordering Example : UTA - 80401 - White-30w - N - W30 - 120v - Options

PROJECT: _____ DATE: _____

TYPE: _____ QUANTITY: _____ NOTE: _____

Ligman Lighting USA reserves the right to change specifications without prior notice, please contact factory for latest information.
 Due to the continual improvements in LED technology data and components may change without notice.

